

**SUMMARY REPORT TO MANAGER**  
for City Council Meeting of 11/14/05

**SUBJECT:** Resolution to make Traffic Control Orders P-05-11, P-05-12, R-05-01, R-05-02, R-05-03, S-05-06, and S-05-07 permanent.

**INITIATED BY:** Bradd D. Maki, Assistant City Engineer *BDM*

**RESOLUTION SUMMARY:**

- a. Traffic Control Order No. P-05-11, This resolution establishes that parking shall be prohibited on the north side of E. Sugnet Road between Swede Avenue and McKeith Street, and on the south side of E. Sugnet Road between Swede Avenue and 150 feet west of McKeith Street.
- b. Traffic Control Order No. P-05-12, This resolution establishes that parking shall be prohibited on Jefferson Avenue from 200 feet north of Broadhead to Letts Road
- c. Traffic Control Order No. R-05-01, This resolution establishes that the speed limit on Jefferson Avenue between Wackerly Street and 200 feet north of Julie Ann Court shall be 35 m.p.h., and that TCO R-98-02 be rescinded.
- d. Traffic Control Order No. R-05-02, This resolution establishes that the speed limit on Jefferson Avenue between Letts Road and 200 feet north of Julie Ann Court shall be 45 m.p.h.
- e. Traffic Control Order No. R-05-03, This resolution establishes that the speed limit on Countryside Drive shall be 35 m.p.h.
- f. Traffic Control Order No. S-05-06, This resolution establishes that Fast Ice Drive shall stop for Bay City Road.
- g. Traffic Control Order No. S-05-07, This resolution establishes that Ross Court shall stop for Mertz Street.

**ITEMS ATTACHED:**

- 1. Summary Letter to City Manager
- 2. Resolutions
- 3. Location Maps

**CITY COUNCIL ACTION:**

3/5 vote required to adopt resolution

**SUBMITTED BY:** Bradd Maki



City Hall • 333 West Ellsworth Street • Midland, Michigan 48640-5132 • 989.837.3300 • 989.835.2717 Fax • [www.midland-mi.org](http://www.midland-mi.org)

TO: Karl Tomion, City Manager

FROM: Bradd Maki, Assistant City Engineer *BSM*

DATE: November 8, 2005

SUBJECT: Traffic Control Orders P-05-11, P-05-12, R-05-01, R-05-02, R-05-03, S-05-06, and S-05-07

Traffic Control Orders P-05-11, P-05-12, R-05-01, R-05-02, R-05-03, S-05-06, and S-05-07 have been in place the required trial period and are now ready to be considered by City Council. The traffic control actions undertaken are described in the attached resolutions and would become permanent upon acceptance by the City Council.

We have not received any adverse comments regarding these traffic control orders.

S:/TCO NOV 14, 2005.LTR



City Hall • 333 West Ellsworth Street • Midland, Michigan 48640-5132 • 989.837.3300 • 989.835.2717 Fax • www.midland-mi.org

BY COUNCILMAN

RESOLVED, that Traffic Control Order No. P-05-11 filed July 25, 2005 pursuant to Chapter 24 of the Code of Ordinances to establish traffic control as follows:

That parking shall be prohibited on the north side of E. Sugnet Road between Swede Avenue and McKeith Street, and on the south side of E. Sugnet Road between Swede Avenue and 150 feet west of McKeith Street.

is hereby made permanent.

YEAS:

NAYS:

ABSENT:

I, Selina Tisdale, City Clerk, City of Midland, Counties of Bay and Midland, State of Michigan, do hereby certify that the foregoing is a true and correct copy of a resolution adopted by a yea vote of all the Councilmen present at a regular meeting of the City Council held Monday, November 14, 2005.

\_\_\_\_\_  
Selina Tisdale, City Clerk



City Hall • 333 West Ellsworth Street • Midland, Michigan 48640-5132 • 989.837.3300 • 989.835.2717 Fax • www.midland-mi.org

BY COUNCILMAN

RESOLVED, that Traffic Control Order No. P-05-12 filed July 25, 2005 pursuant to Chapter 24 of the Code of Ordinances to establish traffic control as follows:

That parking shall be prohibited on Jefferson Avenue from 200 feet north of Broadhead to Letts Road.

is hereby made permanent.

YEAS:

NAYS:

ABSENT:

I, Selina Tisdale, City Clerk, City of Midland, Counties of Bay and Midland, State of Michigan, do hereby certify that the foregoing is a true and correct copy of a resolution adopted by a yeas vote of all the Councilmen present at a regular meeting of the City Council held Monday, November 14, 2005.

\_\_\_\_\_  
Selina Tisdale, City Clerk



City Hall • 333 West Ellsworth Street • Midland, Michigan 48640-5132 • 989.837.3300 • 989.835.2717 Fax • www.midland-mi.org

BY COUNCILMAN

RESOLVED, that Traffic Control Order No. R-05-01 filed July 25, 2005 pursuant to Chapter 24 of the Code of Ordinances to establish traffic control as follows:

That the speed limit on Jefferson Avenue between Wackerly Street and 200 feet north of Julie Ann Court shall be 35 m.p.h., and that TCO R-98-02 be rescinded.

is hereby made permanent.

YEAS:

NAYS:

ABSENT:

I, Selina Tisdale, City Clerk, City of Midland, Counties of Bay and Midland, State of Michigan, do hereby certify that the foregoing is a true and correct copy of a resolution adopted by a yeas vote of all the Councilmen present at a regular meeting of the City Council held Monday, November 14, 2005.

\_\_\_\_\_  
Selina Tisdale, City Clerk



City Hall • 333 West Ellsworth Street • Midland, Michigan 48640-5132 • 989.837.3300 • 989.835.2717 Fax • www.midland-mi.org

BY COUNCILMAN

RESOLVED, that Traffic Control Order No. R-05-02 filed July 25, 2005 pursuant to Chapter 24 of the Code of Ordinances to establish traffic control as follows:

That the speed limit on Jefferson Avenue between Letts Road and 200 feet north of Julie Ann Court shall be 45 m.p.h..

is hereby made permanent.

YEAS:

NAYS:

ABSENT:

I, Selina Tisdale, City Clerk, City of Midland, Counties of Bay and Midland, State of Michigan, do hereby certify that the foregoing is a true and correct copy of a resolution adopted by a yea vote of all the Councilmen present at a regular meeting of the City Council held Monday, November 14, 2005.

\_\_\_\_\_  
Selina Tisdale, City Clerk



City Hall • 333 West Ellsworth Street • Midland, Michigan 48640-5132 • 989.837.3300 • 989.835.2717 Fax • www.midland-mi.org

BY COUNCILMAN

RESOLVED, that Traffic Control Order No. R-05-03 filed August 22, 2005 pursuant to Chapter 24 of the Code of Ordinances to establish traffic control as follows:

That the speed limit on Countryside Drive shall be 35 m.p.h.

is hereby made permanent.

YEAS:

NAYS:

ABSENT:

I, Selina Tisdale, City Clerk, City of Midland, Counties of Bay and Midland, State of Michigan, do hereby certify that the foregoing is a true and correct copy of a resolution adopted by a yeas vote of all the Councilmen present at a regular meeting of the City Council held Monday, November 14, 2005.

\_\_\_\_\_  
Selina Tisdale, City Clerk



City Hall • 333 West Ellsworth Street • Midland, Michigan 48640-5132 • 989.837.3300 • 989.835.2717 Fax • www.midland-mi.org

BY COUNCILMAN

RESOLVED, that Traffic Control Order No. S-05-06 filed August 17, 2005 pursuant to Chapter 24 of the Code of Ordinances to establish traffic control as follows:

That Fast Ice Drive shall stop for Bay City Road.

is hereby made permanent.

YEAS:

NAYS:

ABSENT:

I, Selina Tisdale, City Clerk, City of Midland, Counties of Bay and Midland, State of Michigan, do hereby certify that the foregoing is a true and correct copy of a resolution adopted by a yea vote of all the Councilmen present at a regular meeting of the City Council held Monday, November 14, 2005.

\_\_\_\_\_  
Selina Tisdale, City Clerk



89

City Hall • 333 West Ellsworth Street • Midland, Michigan 48640-5132 • 989.837.3300 • 989.835.2717 Fax • [www.midland-mi.org](http://www.midland-mi.org)

BY COUNCILMAN

RESOLVED, that Traffic Control Order No. S-05-07 filed August 22, 2005 pursuant to Chapter 24 of the Code of Ordinances to establish traffic control as follows:

That Ross Court shall stop for Mertz Street.

is hereby made permanent.

YEAS:

NAYS:

ABSENT:

I, Selina Tisdale, City Clerk, City of Midland, Counties of Bay and Midland, State of Michigan, do hereby certify that the foregoing is a true and correct copy of a resolution adopted by a        yea vote of all the Councilmen present at a regular meeting of the City Council held Monday, November 14, 2005.

---

Selina Tisdale, City Clerk

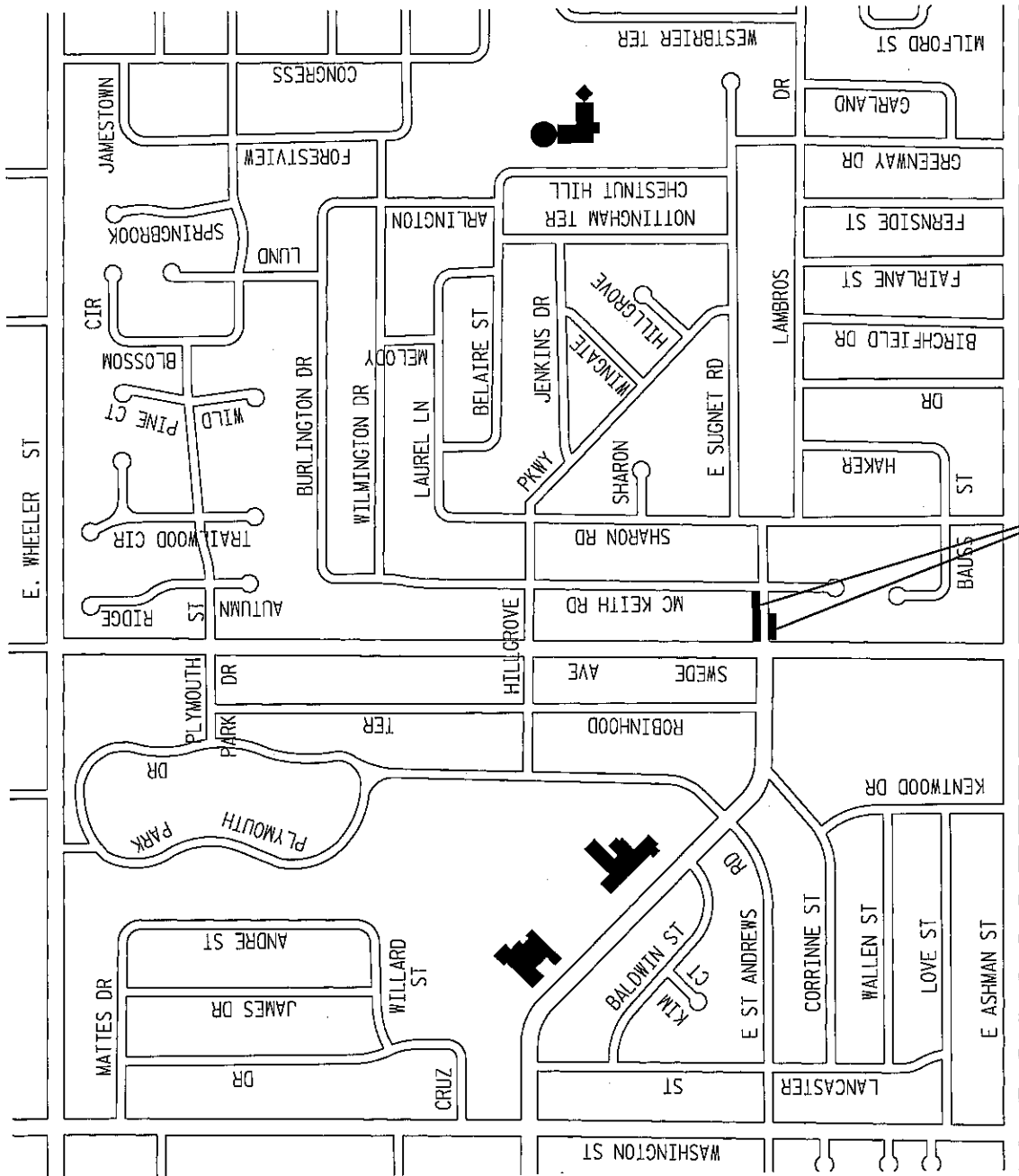

P-05-11

LOCATION MAP  
FOR TRAFFIC CONTROL ORDER NO.  
P-05-11

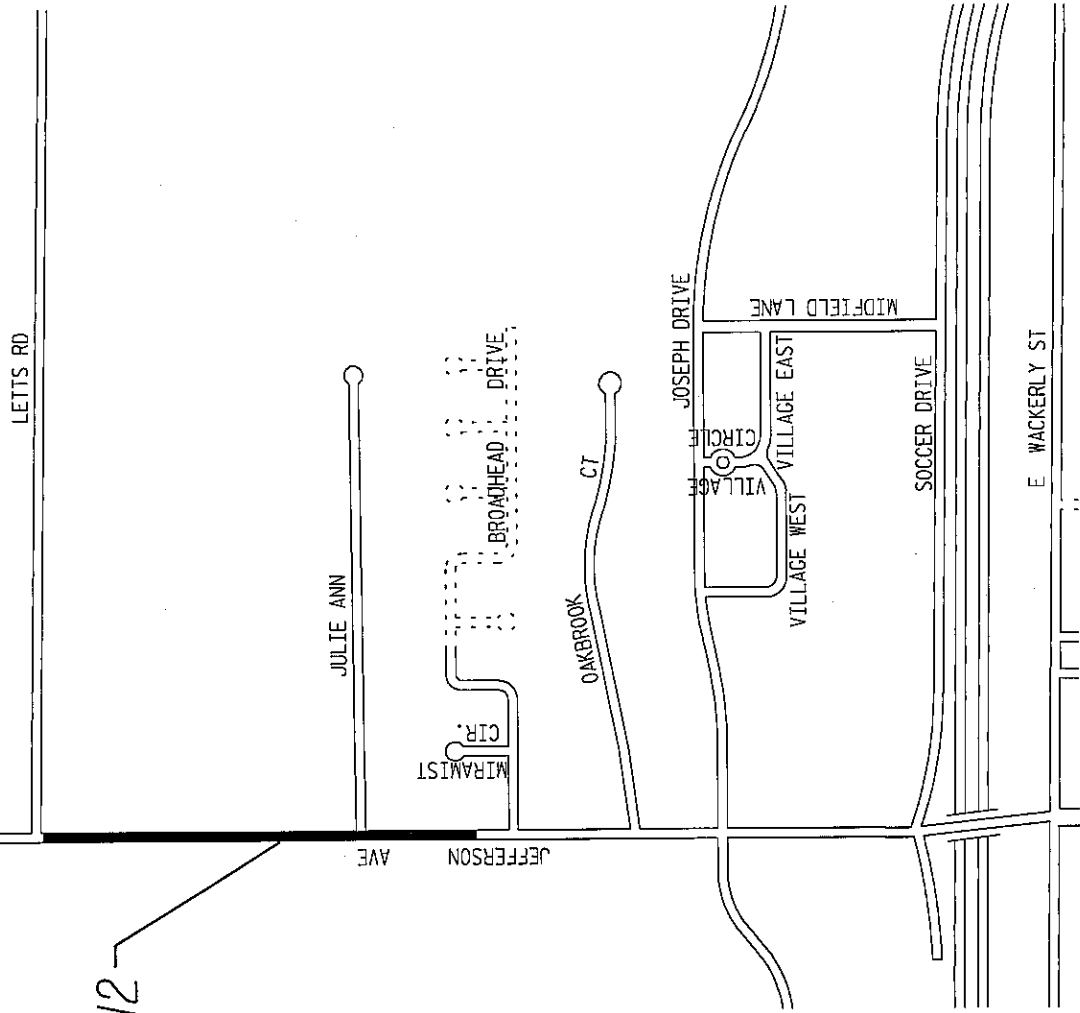

P-05-12

**LOCATION MAP**  
 FOR TRAFFIC CONTROL ORDER NO.  
 P-05-12

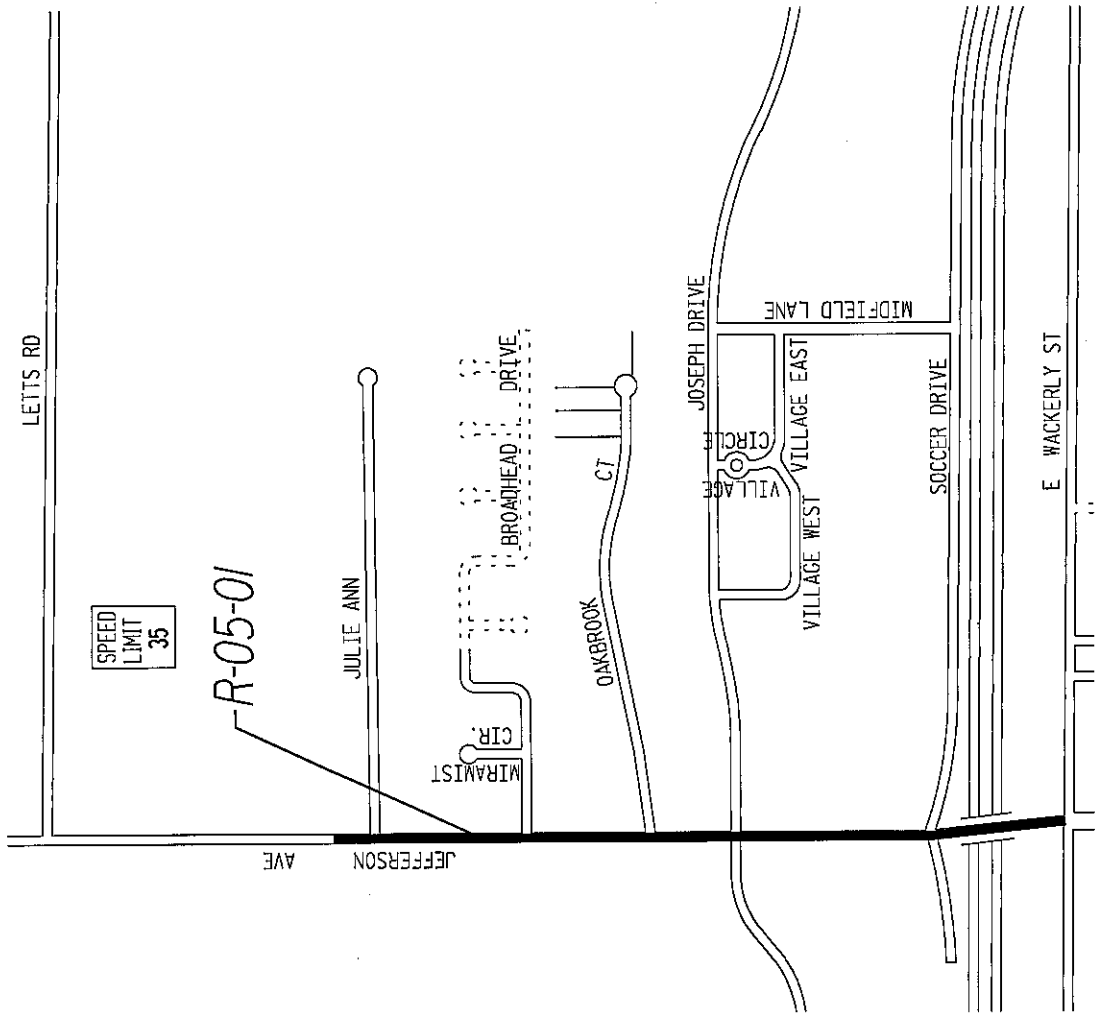

**LOCATION MAP**  
 FOR TRAFFIC CONTROL ORDER NO.  
 R-05-01



SPEED  
LIMIT  
45

R-05-02

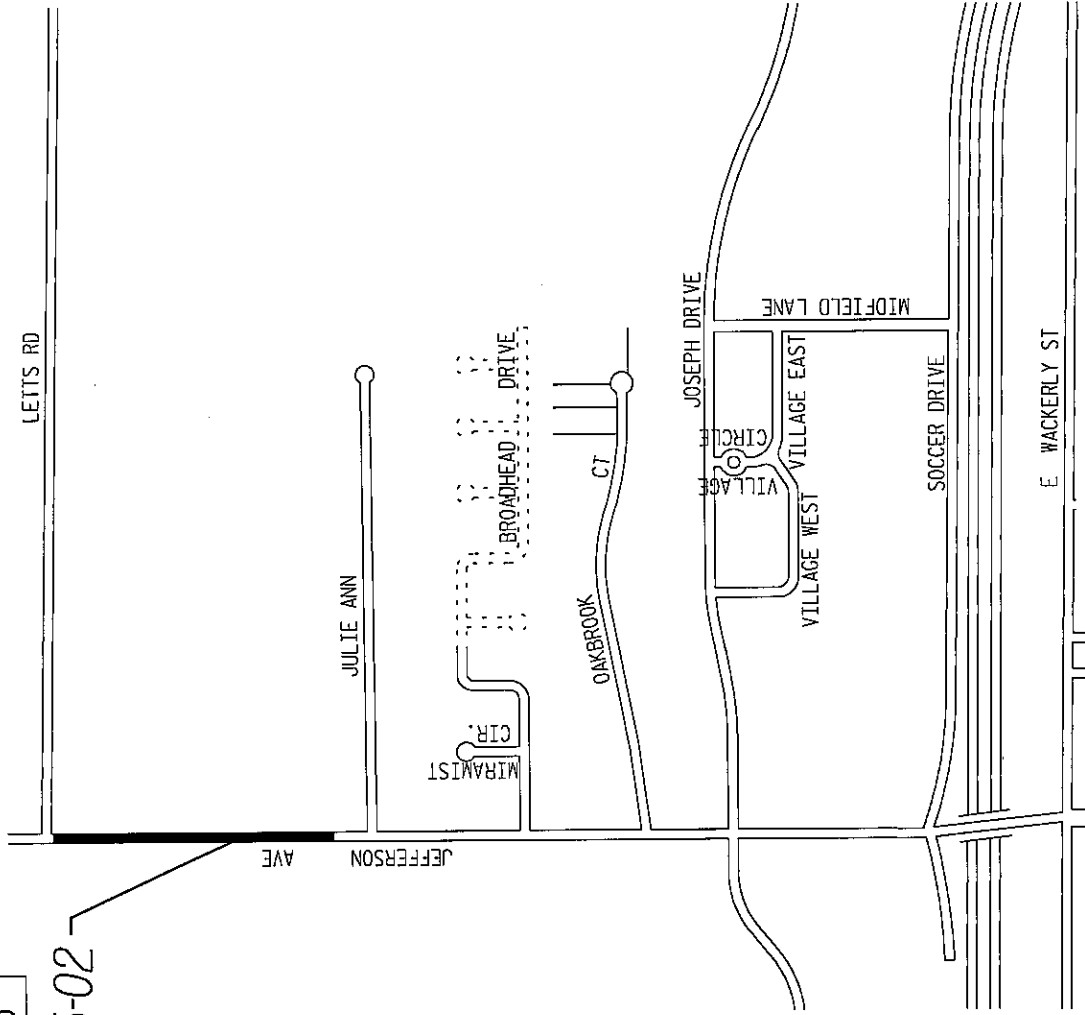

**LOCATION MAP**  
 FOR TRAFFIC CONTROL ORDER NO.  
 R-05-02



SPEED  
LIMIT  
35

R-05-03

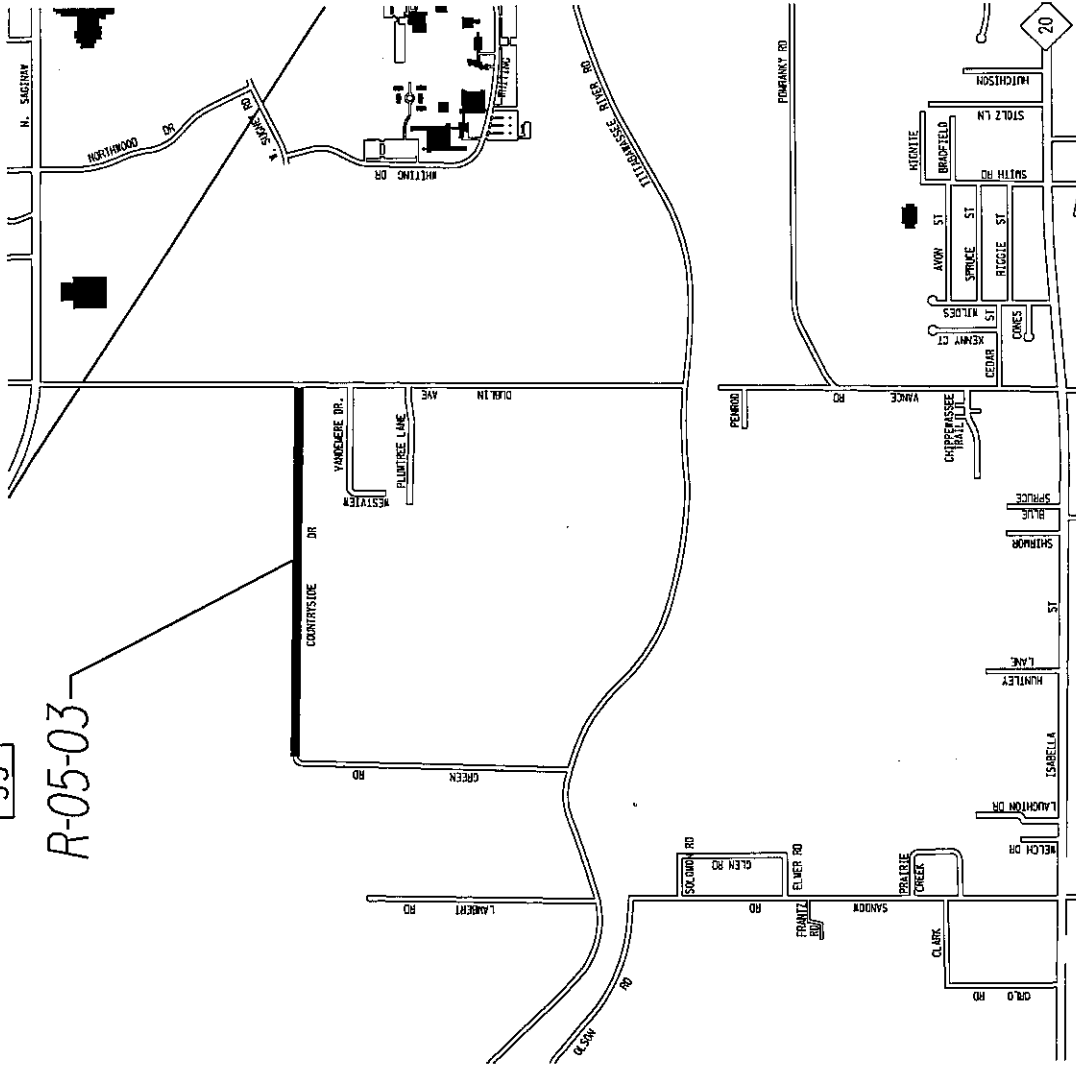

**LOCATION MAP**  
 FOR TRAFFIC CONTROL ORDER NO.  
 R-05-03

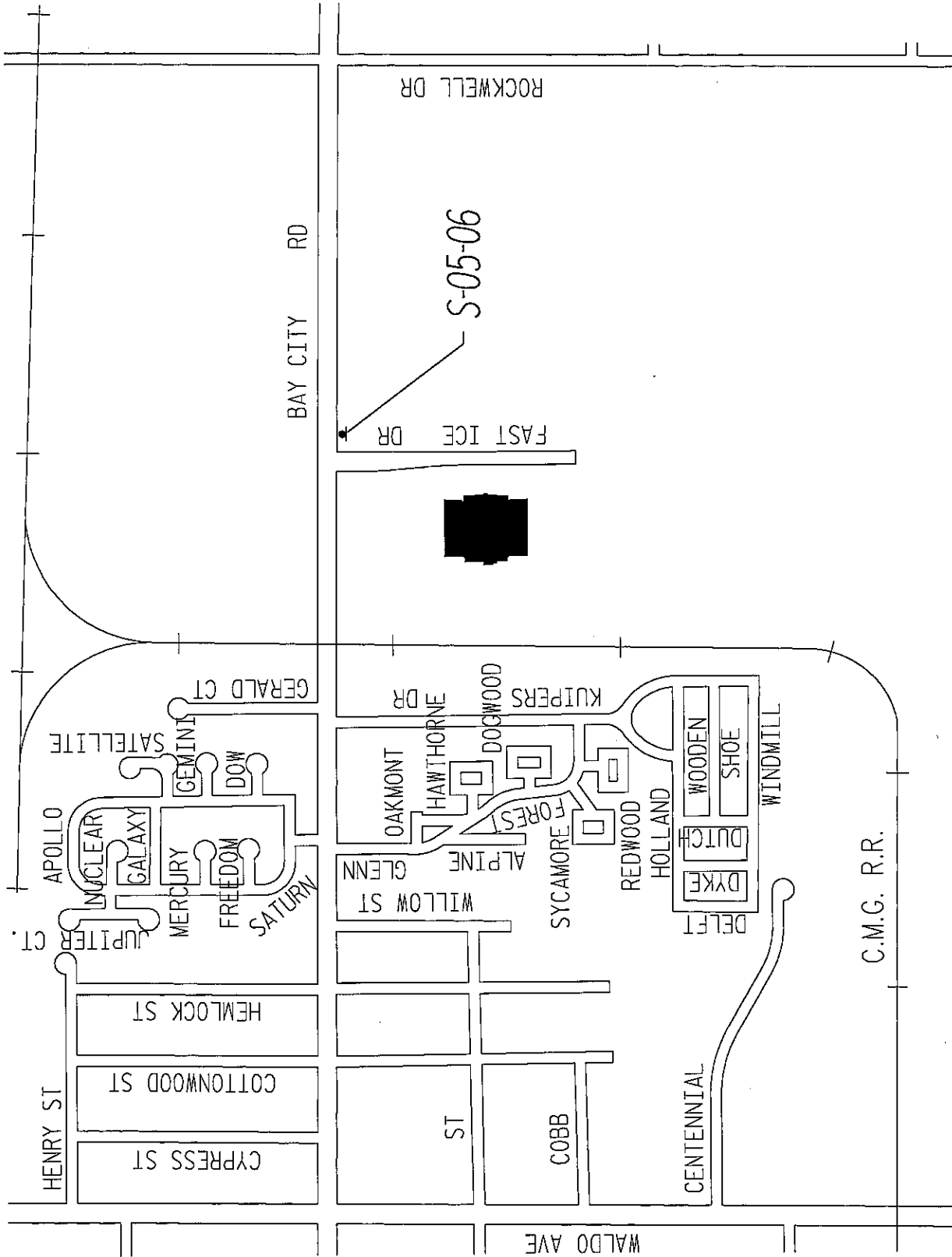

**LOCATION MAP**  
 FOR TRAFFIC CONTROL ORDER NO.  
 S-05-06

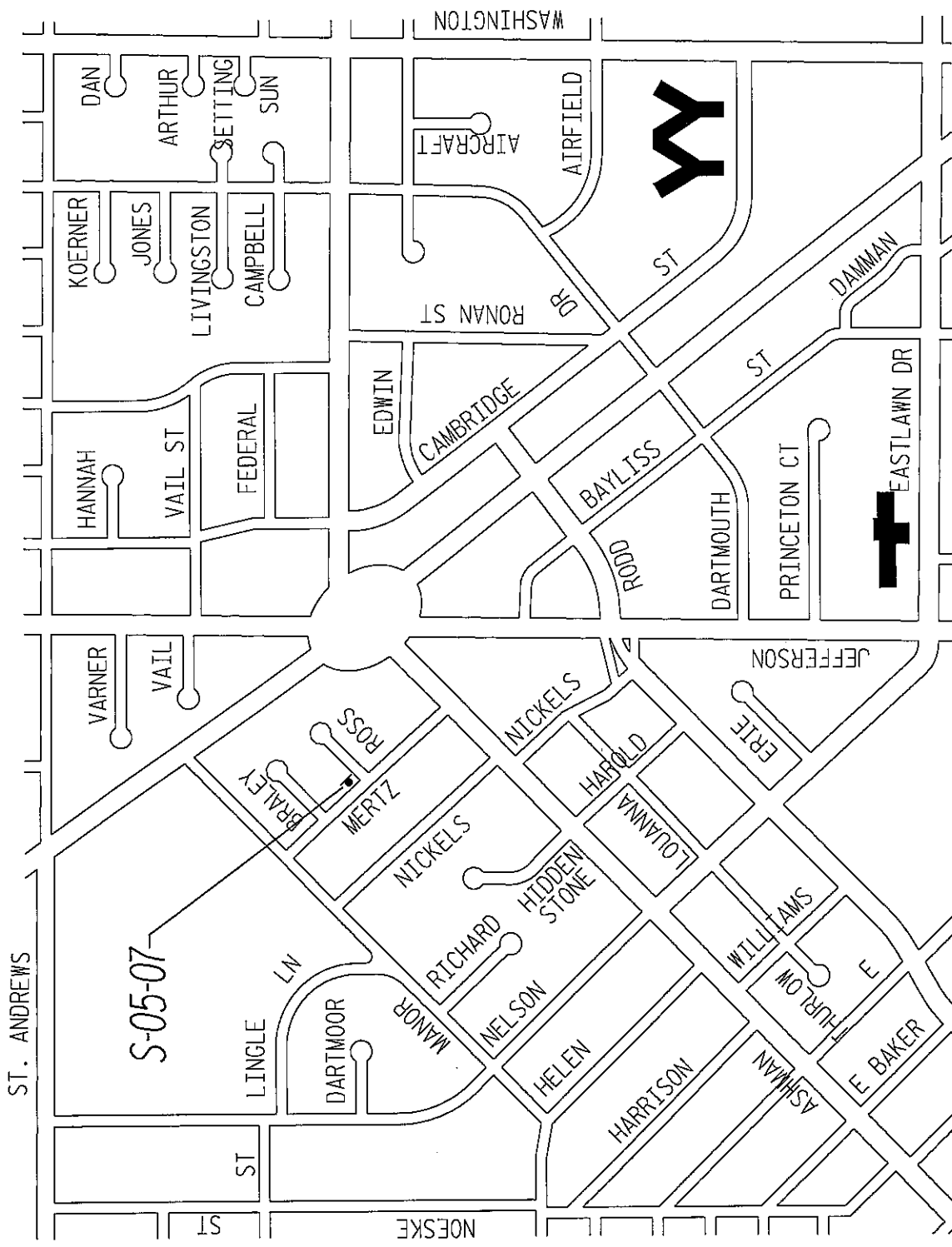

LOCATION MAP  
 FOR TRAFFIC CONTROL ORDER NO.  
 S-05-07