

SUMMARY REPORT TO THE CITY MANAGER
for Council Meeting of January 15, 2007

SUBJECT: 2007/2008 ENGINEERING PROJECT PRIORITIES LISTING

INITIATED BY: City of Midland Engineering Department

ITEMS ATTACHED:

1. Cover Letter
2. Construction Project Priorities Listing
3. Road Millage Cash Flow
4. Location Maps
5. Communication(s)
6. Overall Project Map

CITY COUNCIL ACTION: No Action Needed

SUBMITTED BY: Brian P. McManus, City Engineer *BPM*



City Hall • 333 West Ellsworth Street • Midland, Michigan 48640-5132 • 989.837.3300 • 989.835.2717 Fax • www.midland-mi.org

DATE: January 10, 2007

TO: Jon Lynch, City Manager

FROM: Brian P. McManus, City Engineer *BPM*

RE: 2007/2008 Engineering Projects Priorities Listing

City staff has prepared the infrastructure capital maintenance program priority list for the 2007/2008 City budget.

In accordance with past practice, we have solicited requests for capital improvement projects from residents and interested developers for consideration and possible funding within the upcoming fiscal year budget. These petitions and requests were accepted by City Council on December 4, 2006 and were referred to the Engineering Department for review and recommendation.

The attached list includes all projects requested by interested residents, developers, businesses, industries, etc. referred by the City Council to the staff for review. The list also includes projects requested by Public Services and the Utilities Department and projects established by our review of maintenance operations and the conditions of various major and local streets. The list is organized by fund category including Major Street, Local Street, Water, Sewer, and Miscellaneous General Fund.

We have notified all petitioners regarding this project priority meeting. Individual maps indicating locations of proposed improvements are also included for your information and reference. The attached maps are generally listed in order according to the priority list. We have placed the map for the George Street relocation at the Midland Community Center at the front. The project was requested from the public and we have invited the petitioners to attend the meeting.

The Engineering Department conducts several meetings with DPS maintenance personnel to decide which streets have received the most maintenance and which pavements and curbs are in the worst condition. We also evaluate maintenance requests received from the public.

Our pavement management software program is an important tool used to help determine funding levels for different repair options based primarily on pavement condition, available funds, and benefit to the overall street network.

FUNDING

This year we have updated the cash flow model for County Road millage projects. The cash flow spreadsheet is attached. The cash flow projections assume countywide tax value increases at 2.0% per year and are net of reserves for the pending industrial tax appeal. The current road millage expires after the 2009 levy.

The cash flow model indicates that several projects are under development in the upcoming year. We are proposing work on the Joe Mann Boulevard acquisition, Dow Roadway, the George Street relocation at the Midland Community Center and significant transfer to projects in the Major Street Fund.

Now that an Eastman Avenue improvement concept has been chosen, a financing plan needs to be developed that may include Local, State and Federal monies. Funding for the Eastman Avenue traffic improvements are anticipated to begin during the 2008/09 budget cycle with right-of-way acquisition.

Based upon current budget estimates, analysis of the June 30, 2006 fund balances and review of the County Road millage cash flow model, the following amounts have been estimated to be available for construction projects in 2007-2008:

Major Street Fund	
County Road Millage Revenue	\$ 1,082,000
Gas and Weight Tax	1,100,550
Proceeds from Fund Balance	<u>37,450</u>
	<u>\$ 2,220,000</u>
Local Street Fund	
County Road Millage Revenue	\$683,000
Gas and Weight Tax	34,850
Community Development Block Grant	210,000
Proceeds from Fund Balance	<u>169,150</u>
	<u>\$ 1,097,000</u>
Wastewater Fund	
Community Development Block Grant	\$ 55,000
Operating Revenues	<u>50,000</u>
	<u>\$ 105,000</u>
Water Fund	
Working Capital	\$526,920
Operating Revenues	<u>491,080</u>
	<u>\$ 1,018,000</u>

At this early date, it is difficult to estimate the amount of funding which will be available in the General Fund. This report anticipates \$257,000 in General Fund expenditures.

While these funding levels have been conservatively estimated, we must remember it is early in the budget process and the estimates may need to be revised at a later date. The total of the projects recommended are within the funding levels for the various funds indicated above.

PROJPRIORITY 2007.LTR2

CONSTRUCTION PROJECT PRIORITIES

1/11/2007

MAJOR STREET FUND

PROJECT NAME	TOTAL COST	CITY COST	PROPOSED FUNDING 07/08FY	PRIOR YEARS FUNDING	ESTIMATED COMPLETION DATE	MAP INCLUDED	REMARKS
--------------	------------	-----------	--------------------------	---------------------	---------------------------	--------------	---------

CURRENT PROJECTS (2006/2007F.Y.)

PATRICK ROAD: LYON X-OVER TO SAGINAW	\$219,000	\$219,000	\$0	\$219,000	NOVEMBER '07	✓	
RODD STREET: BOTTLES TO SAGINAW	\$740,000	\$459,000	\$0	\$459,000	NOVEMBER '07	✓	MDOT \$281,000 TEA-21 GRANT
SURFACE TREATMENT AND CRACK SEALING	\$150,000	\$150,000	\$0	\$150,000	JUNE '07		
TRAFFIC SIGN UPGRADE	\$20,000	\$20,000	\$0	\$20,000	JUNE '07		
TRAFFIC SIGNAL UPGRADE	\$50,000	\$50,000	\$0	\$50,000	JUNE '07		
TRAFFIC SIGNAL I.E.D. IMPLEMENTATION	\$235,000	\$235,000	\$45,000	\$87,000	JUNE '08		
WALDO AVENUE: HENRY TO EASTLAWN	\$455,000	\$455,000	\$0	\$455,000	NOVEMBER '07	✓	
TOTAL	\$1,869,000	\$1,588,000	\$45,000	\$1,440,000			

PROPOSED PROJECTS (2007/2008 F.Y.)

SAGINAW ROAD WIDENING: SUGNET TO TUCKER	\$895,000	\$355,000	\$355,000	\$0	NOVEMBER '07	✓	MDOT \$375,000 TEA-21 & \$93,750 JOBS TODAY GRANT
CINEMA DRIVE: MALL ROAD TO N.S. 1/4 LINE	\$104,000	\$104,000	\$104,000	\$0	NOVEMBER '08	✓	
EASTLAWN DRIVE: JEFFERSON TO WASHINGTON	\$311,000	\$311,000	\$311,000	\$0	NOVEMBER '08	✓	
HALEY STREET: WASHINGTON TO SWEDE	\$249,000	\$249,000	\$249,000	\$0	NOVEMBER '08	✓	
SUGNET ROAD: ORCHARD TO EASTMAN	\$201,000	\$201,000	\$201,000	\$0	NOVEMBER '08	✓	
SUGNET ROAD: WASHINGTON TO SWEDE	\$290,000	\$290,000	\$290,000	\$0	NOVEMBER '08	✓	
SURFACE TREATMENT AND CRACK SEALING	\$200,000	\$200,000	\$200,000	\$0	JUNE '08		
TRAFFIC SIGN UPGRADE	\$20,000	\$20,000	\$20,000	\$0	JUNE '08		
TRAFFIC SIGNAL UPGRADE	\$75,000	\$75,000	\$75,000	\$0	JUNE '08		
TOTAL	\$2,345,000	\$1,805,000	\$1,850,000	\$0			

SPECIAL PROJECTS

EASTMAN AVENUE TRAFFIC IMPROVEMENTS: ENGINEERING	\$150,000	\$150,000	\$0	\$150,000	2007	✓	COUNTY ROAD MILLAGE FUNDING
JOE MANN BLVD / JEFFERSON AVE.: R.O.W. ACQUISITION	\$500,000	\$500,000	\$160,000	\$40,000	2008	✓	COUNTY ROAD MILLAGE FUNDING
*DOW ROADWAY: JAMES SAVAGE CLOSURE AT SAGINAW RD	\$60,000	\$60,000	\$60,000	\$0	2007	✓	COUNTY ROAD MILLAGE FUNDING
*GEORGE STREET RELOC. FOR MIDLAND COMMUNITY CENTER	\$300,000	\$150,000	\$150,000	\$0	2007	✓	COUNTY ROAD MILLAGE FUNDING
LETTIS ROAD: EASTMAN TO JEFFERSON	\$1,400,000	\$1,400,000	\$0	\$1,400,000	2007	✓	COUNTY ROAD MILLAGE FUNDING
TOTAL	\$4,755,000	\$4,065,000	\$2,220,000	\$1,590,000			

* - PETITIONED PROJECT

CONSTRUCTION PROJECT PRIORITIES

PROJECT NAME	TOTAL COST	CITY COST	PROPOSED FUNDING DATE	PRIOR YEARS FUNDING	ESTIMATED COMPLETION DATE	MAP INCLUDED	REMARKS
--------------	------------	-----------	-----------------------	---------------------	---------------------------	--------------	---------

FUTURE SPECIAL PROJECTS (2008 AND BEYOND)

EASTMAN AVENUE TRAFFIC IMPROVEMENTS	\$3,800,000	\$3,800,000	\$0	\$0	2010		FUNDING UNDETERMINED
SUGNET EXTENSION: MAIN TO DUELN	\$1,100,000	\$1,100,000	\$0	\$0	2015		COUNTY ROAD MILLAGE FUNDING
TOTAL	\$4,900,000	\$4,900,000	\$0	\$0			

FUTURE PROJECTS (2008/2009 F.Y. AND BEYOND)

SAGINAW: 1 MILE SOUTH OF SALZBURG TO GORDONVILLE	\$523,000		1				
SURFACE TREATMENT AND CRACK SEALING	\$200,000		1				
SWEDE: ASHMAN TO WHEELER	\$513,000		1				
SUBTOTAL FOR PRIORITY 1				\$1,236,000			
ASHMAN: WALDO TO US-10	\$239,000		2				
BARTH STREET: PERSHING TO BAYLISS	\$76,000		2				
BAY CITY ROAD: WALDO TO WALTER	\$377,000		2				
BAYLISS STREET: LYON TO PATRICK	\$41,000		2				
ST. ANDREWS: WASHINGTON TO SUGNET	\$224,000		2				
SUGNET: EASTMAN TO SAGINAW	\$347,000		2				
SUBTOTAL FOR PRIORITY 2				\$1,304,000			
CARPENTER: LYON TO JEFFERSON	\$61,000		3				
SAGINAW: DOW CORNING TO SALZBURG	\$285,000		3				
SALZBURG: SAGINAW TO WALDO	\$270,000		3				
WASHINGTON: PATRICK TO SAGINAW	\$242,000		3				
SUBTOTAL FOR PRIORITY 3				\$858,000			
TOTAL LISTED FUTURE PROJECTS	\$3,398,000						

* - PETITIONED PROJECT

LOCAL STREET FUND

CONSTRUCTION PROJECT PRIORITIES

PROJECT NAME	TOTAL	CITY COST	PROPOSED FUNDING 07/08 FY	PRIOR YEARS FUNDING	ESTIMATED COMPLETION	MAP INCLUDED	REMARKS
LETTS STREET: STURGEON ROAD TO STURGEON CREEK	\$129,000	\$129,000	\$0	\$129,000	NOVEMBER '07	✓	
SANDOW AREA (ELMER, GLEN, SANDOW, SOLOMON, PRAIRIE)	\$574,000	\$574,000	\$0	\$574,000	NOVEMBER '07	✓	
SURFACE TREATMENT AND CRACK SEALING	\$150,000	\$150,000	\$0	\$150,000	JUNE '07		
	\$853,000	\$853,000	\$0	\$853,000			
PROPOSED PROJECTS (2007/2008 F.Y.)							
PLYMOUTH PARK DRIVE: PLYMOUTH STREET TO PARK EXIT	\$110,000	\$110,000	\$110,000	\$0	NOVEMBER '07	✓	INCLUDES DRAINAGE AND SPEED TABLES
LAUGHTON DRIVE: ISABELLA TO END OF STREET	\$112,000	\$112,000	\$112,000	\$0	NOVEMBER '07	✓	CDBG FUNDING
WEIUCH DRIVE: ISABELLA TO END OF STREET	\$98,000	\$98,000	\$98,000	\$0	NOVEMBER '07	✓	CDBG FUNDING
CURB REPLACEMENT AND PAVEMENT PATCHING PROGRAM	\$150,000	\$150,000	\$150,000	\$0	NOVEMBER '08		
DARIMOOR PLACE: NELSON TO END OF COURT	\$47,000	\$47,000	\$47,000	\$0	NOVEMBER '08	✓	
LEXINGTON COURT: CONCORD TO END OF COURT	\$108,000	\$108,000	\$108,000	\$0	NOVEMBER '08	✓	
NORWICH STREET: WASHINGTON TO END OF COURT	\$125,000	\$125,000	\$125,000	\$0	NOVEMBER '08	✓	
SURFACE TREATMENT AND CRACK SEALING	\$300,000	\$300,000	\$300,000	\$0	JUNE '08		
VALORIE LANE: STURGEON TO ST. MARYS	\$47,000	\$47,000	\$47,000	\$0	NOVEMBER '08	✓	
	\$1,097,000	\$1,097,000	\$1,097,000	\$0			
SPECIAL ASSESSMENT PROJECTS (2007/2008 F.Y.)							
	\$0	\$0	\$0	\$0			
TOTAL	\$1,097,000	\$1,097,000	\$1,097,000	\$0			

* - PETITIONED PROJECT

CONSTRUCTION PROJECT PRIORITIES

LOCAL STREET FUND

FUTURE PROJECTS (2008/2009 F.Y. AND BEYOND)	TOTAL COST	PRIORITY CODE	
BALDWIN: LANCASTER TO SUGNET	\$144,000	1	
BARTO: CAMPAU TO LUHRING	\$115,000	1	
BLARNEY: STURGEON CK TO LEBWAY	\$78,000	1	
HANNAH: CAMBRIDGE TO END OF COURT	\$61,000	1	
HEDGEWOOD: SAGINAW TO GOLDENWOOD	\$182,000	1	
LEBWAY: MOORLAND TO END OF STREET	\$110,000	1	
LESSA: LUHRING TO ST. MARYS	\$35,000	1	
LUHRING: LESSA TO BARTO	\$92,000	1	
MOORLAND: WOODBRIDGE TO END	\$254,000	1	
SURFACE TREATMENT AND CRACK SEALING	\$300,000	1	
SUBTOTAL FUTURE PRIORITY 1	\$1,371,000		
BUCHANAN: VAN BUREN TO COOLIDGE	\$455,000	2	
OAKRIDGE: DUBLIN TO PARTRIDGE	\$190,000	2	
PARTRIDGE: OAKRIDGE TO WACKERLY	\$87,000	2	
PRINCETON: JEFFERSON TO END	\$102,000	2	
ST. MARYS: DRAKE TO LESSA	\$105,000	2	
ST. MARYS: VALORIE TO DRAKE	\$182,000	2	
VIRGINIA: HALLEY TO EASTLAWN	\$131,000	2	
SUBTOTAL FUTURE PRIORITY 2	\$1,252,000		
AVON STREET: WILDES TO SMITH	\$149,000	3	
BURRELL COURT	\$53,000	3	
CAMBRIDGE: BOSTON TO ST. ANDREWS	\$197,000	3	
HALLSY: STONY CREEK TO END	\$25,000	3	
NOESKE: HELEN TO BALFOUR	\$119,000	3	
PARTRIDGE: OAKRIDGE TO WOODBRIDGE	\$143,000	2	
TOWNSEND: BUTTLES TO PINE	\$154,000	3	
TOWNSEND: PINE TO CARPENTER	\$142,000	3	
WINTERGREEN: STURGEON CK PKWY TO WOODSIDE	\$76,000	3	
WOODSIDE: STURGEON CK PKWY TO WINTERGREEN	\$65,000	3	
SUBTOTAL FUTURE PRIORITY 3	\$1,123,000		
TOTAL FUTURE PROJECTS	\$3,746,000		

CONSTRUCTION PROJECT PRIORITIES

1/11/2007

SANITARY SEWER PROJECTS

PROJECT NAME	TOTAL COST	CITY COST	PROPOSED FUNDING 07/08 FY	PRIOR YEARS FUNDING	ESTIMATED COMPLETION DATE	MAP INCLUDED	REMARKS
--------------	------------	-----------	---------------------------	---------------------	---------------------------	--------------	---------

CURRENT PROJECTS (2006/2007 F.Y.)

*ROCKWELL DRIVE: FISHER ROAD TO EAST ICE DRIVE	\$16,000	\$50,000	\$0	\$50,000	JUNE '07	✓	CITY PAYS FOR EX. DEPTH & NON-ASSES. FRONT.
RODD STREET: SAGINAW TO BUTTLES	\$100,000	\$100,000	\$50,000	\$50,000	NOVEMBER '07	✓	SEWER REPAIRS DURING STREET RECONST.
WALDO AVENUE: HENRY TO EASTLAWN	\$50,000	\$50,000	\$0	\$50,000	NOVEMBER '07	✓	SEWER REPAIRS DURING STREET RECONST.
UNION STREET: STATE TO 200 FEET WEST	\$24,000	\$20,000	\$0	\$20,000	NOVEMBER '07	✓	
	\$250,000	\$220,000	\$50,000	\$170,000			

PROPOSED PROJECTS (2007/08 F.Y.)

LAUGHTON DRIVE: ISABELLA TO END OF STREET	\$30,000	\$30,000	\$30,000	\$0	NOVEMBER '07	✓	CDBG FUNDING
WELCH DRIVE: ISABELLA TO END OF STREET	\$25,000	\$25,000	\$25,000	\$0	NOVEMBER '07	✓	CDBG FUNDING
	\$55,000	\$55,000	\$55,000	\$0			

SPECIAL ASSESSMENT PROJECTS (2007/08 F.Y.)

TOTAL	\$0	\$0	\$0	\$0			
	\$55,000	\$55,000	\$105,000	\$0			

*-PETITIONED PROJECT

CONSTRUCTION PROJECT PRIORITIES

1/11/2007

MISCELLANEOUS GENERAL FUND PROJECTS

PROJECT NAME	TOTAL COST	CITY COST	PROPOSED FUNDING 07/08 FY	PRIOR YEARS FUNDING	ESTIMATED COMPLETION DATE	MAP INCLUDED	REMARKS
--------------	------------	-----------	---------------------------	---------------------	---------------------------	--------------	---------

CURRENT PROJECTS (2006/07 F.Y.)

STREET LIGHT UPGRADES	\$40,000	\$40,000	\$0	\$40,000	JUNE '07		
SEWER SEPARATION: MISC. LOCATIONS	\$30,000	\$30,000	\$0	\$30,000	JUNE '07		
	\$70,000	\$70,000	\$0	\$70,000			

PROPOSED PROJECTS (2007/08 F.Y.)

SAGINAW ROAD DRAIN EXTENSIONS	\$72,000	\$72,000	\$72,000	\$0	NOVEMBER '07	✓	2 SNAKE CREEK DRAIN EXT. FOR ROAD WIDENING
CATCH BASIN LEAD REPLACEMENTS	\$30,000	\$30,000	\$30,000	\$0	NOVEMBER '08		REPLACE LEADS DURING STREET RECONSTRUCTION
SIDEWALK IMPROVEMENT PROGRAM	\$80,000	\$80,000	\$80,000	\$0	AUGUST '07		
SEWER SEPARATION: MISC. LOCATIONS	\$30,000	\$30,000	\$30,000	\$0	JUNE '08		
WAY-FINDING SIGN MAINTENANCE	\$25,000	\$25,000	\$25,000	\$0	JUNE '08		ANNUAL BUDGET FOR SIGN MAINT. & REPL.
	\$257,000	\$257,000	\$257,000	\$0			

SPECIAL ASSESSMENT PROJECTS (2007/08 F.Y.)

TOTAL	\$0	\$0	\$0	\$0			
	\$257,000	\$257,000	\$257,000	\$0			

* - PETITIONED PROJECT

WATER PROJECTS

CONSTRUCTION PROJECT PRIORITIES

PROJECT NAME	TOTAL COST	CITY COST	PROPOSED FUNDING 07/08 FY	PRIOR YEARS FUNDING	ESTIMATED COMPLETION DATE	MAP INCLUDED	REMARKS
CURRENT PROJECTS (2006/07 F.Y.)							
*FAST ICE DRIVE: END CENTENNIAL TO BEND IN FAST ICE	\$195,000	\$195,000	\$0	\$195,000	JUNE '07	✓	12" DIST. MAIN UNDER RAILROAD
PATRICK ROAD: SAGINAW TO SWEDE	\$178,000	\$178,000	\$0	\$178,000	NOVEMBER '07	✓	REPLACE WITH NEW 12" WM
RODD STREET: NELSON TO JEFFERSON	\$143,000	\$143,000	\$0	\$143,000	NOVEMBER '07	✓	REPLACE WITH NEW 8" WM
RODD ST.: BAYLISS, JEFFERSON AND SAGINAW CROSSINGS	\$81,000	\$81,000	\$0	\$81,000	NOVEMBER '07	✓	REPLACE WITH NEW 8 & 10" WM
	\$597,000	\$597,000	\$0	\$597,000			
PROPOSED PROJECTS (2007/08 F.Y.)							
FULLER DRIVE: CROSSING AT WALDO	\$25,000	\$25,000	\$25,000	\$0	NOVEMBER '08	✓	REPLACE WITH NEW 10" WM
LEXINGTON COURT: CONCORD TO END OF COURT	\$110,000	\$110,000	\$110,000	\$0	NOVEMBER '08	✓	REPLACE WITH NEW 8" WM
MAIN STREET: VALLEY PUMP HOUSE TO SUGNET ROAD	\$592,000	\$592,000	\$592,000	\$0	NOVEMBER '08	✓	NEW 24" TRANSMISSION MAIN
SUGNET ROAD: ORCHARD TO EASTMAN	\$291,000	\$291,000	\$291,000	\$0	NOVEMBER '08	✓	REPLACE WITH NEW 12" WM
	\$1,018,000	\$1,018,000	\$1,018,000	\$0			
SPECIAL ASSESSMENT PROJECTS (2007/08)							
	\$1,018,000	\$1,018,000	\$1,018,000	\$0			
FUTURE PROJECTS (2008/2009 F.Y. AND BEYOND)							
WASHINGTON: PATRICK TO HALLEY	\$134,000	\$134,000					REPLACE EXISTING WITH NEW 8" WM
PERLINE ROAD: MOORLAND TO WACKERLY	\$277,000	\$277,000					REPLACE EXISTING WITH NEW 12" WM
DILLOWAY DRIVE: 300'E. OF EASTMAN TO SHEBERT	\$218,000	\$218,000					REPLACE EXISTING WITH NEW 8" WM
JEFFERSON AVENUE: HALLEY TO EASTLAWN	\$216,000	\$216,000					REPLACE EXISTING WITH NEW 12" WM
WACKERLY STREET: JEFFERSON TO SWEDE	\$629,000	\$629,000					REPLACE EXISTING WITH NEW 12" WM
OHIO STREET: CAROLINA TO SWEDE	\$208,000	\$208,000					REPLACE EXISTING WITH NEW 8" WM
SAGINAW ROAD: 1800 S. OF SALZBURG TO 500 W. OF WALDO	\$276,000	\$276,000					REPLACE EXISTING WITH NEW 8" WM
DIAMOND DRIVE: MIDFIELD LANE TO SWEDE HWY. X-ING	\$287,000	\$287,000					REPLACE EXISTING WITH NEW 8" WM
WALDO AVENUE: ASHMAN TO WHEELER	\$760,000	\$760,000					NEW 24" TRANSMISSION MAIN
STURGEON AVENUE: ARBAGL TO WACKERLY	\$286,000	\$286,000					REPLACE EXISTING WITH NEW 12" WM
BUCHANAN STREET: VANBUREN TO COOLIDGE	\$248,000	\$248,000					REPLACE EXISTING WITH NEW 8" WM
WALTER STREET: BAY CITY ROAD TO SOUTH END	\$141,000	\$141,000					REPLACE EXISTING WITH NEW 8" WM
BAYLISS STREET: HALLEY TO EASTLAWN	\$219,000	\$219,000					REPLACE EXISTING WITH NEW 8" WM
MICHIGAN STREET: HALLEY TO EASTLAWN	\$253,000	\$253,000					REPLACE EXISTING WITH NEW 8" WM
CHERRY STREET: BAYLISS TO MICHIGAN	\$100,000	\$100,000					REPLACE EXISTING WITH NEW 8" WM
WALNUT STREET: BAYLISS TO MICHIGAN	\$134,000	\$134,000					REPLACE EXISTING WITH NEW 8" WM
MAPLE STREET: BAYLISS TO MICHIGAN	\$168,000	\$168,000					REPLACE EXISTING WITH NEW 8" WM
WACKERLY STREET: INDIAN RIDGE TO JEFFERSON	\$370,000	\$370,000					REPLACE EXISTING WITH NEW 12" WM
FULLER & MARK TWAIN	\$379,000	\$379,000					REPLACE EXISTING WITH NEW 8" WM
LETTIS STREET: MAMMOTH PINES TO STURGEON	\$191,000	\$191,000					NEW 12" TRANSMISSION MAIN

**CITY OF MIDLAND
COUNTY ROAD MILLAGE
PROJECTED REVENUES AND EXPENDITURES
(in thousands)**

	(1) Remaining Voter Authorized Period 2007-08	(2) 2008-09	(3) 2009-10	(4) 2010-11	(5) 2011-12	Total
Carryover from prior year	\$ 151	\$ 123	\$ 796	\$ 1,953	\$ 2,964	\$ 151
Annual Revenue	1,737	1,770	2,286	2,175	2,265	10,233
Total Available Revenue	1,888	1,893	3,082	4,128	5,229	10,384
Expenditures	1,765	1,097	1,129	1,164	1,197	6,352
Accumulated for future projects	\$ 123	\$ 796	\$ 1,953	\$ 2,964	\$ 4,032	\$ 4,032

**CITY OF MIDLAND
COUNTY ROAD MILLAGE
PROJECTED EXPENDITURES BY PROJECT
(in thousands)**

	(1) 2007-08	(2) 2008-09	(3) 2009-10	(4) 2010-11	(5) 2011-12	Total
Joe Mann Blvd	\$ 160	\$ -	\$ -	\$ -	\$ -	\$ 160
George Street relocation	150	-	-	-	-	150
Dow Roadway	60	-	-	-	-	60
Major Street	712	393	405	418	430	2,358
Local Street	683	704	724	746	767	3,624
Totals	\$ 1,765	\$ 1,097	\$ 1,129	\$ 1,164	\$ 1,197	\$ 6,352

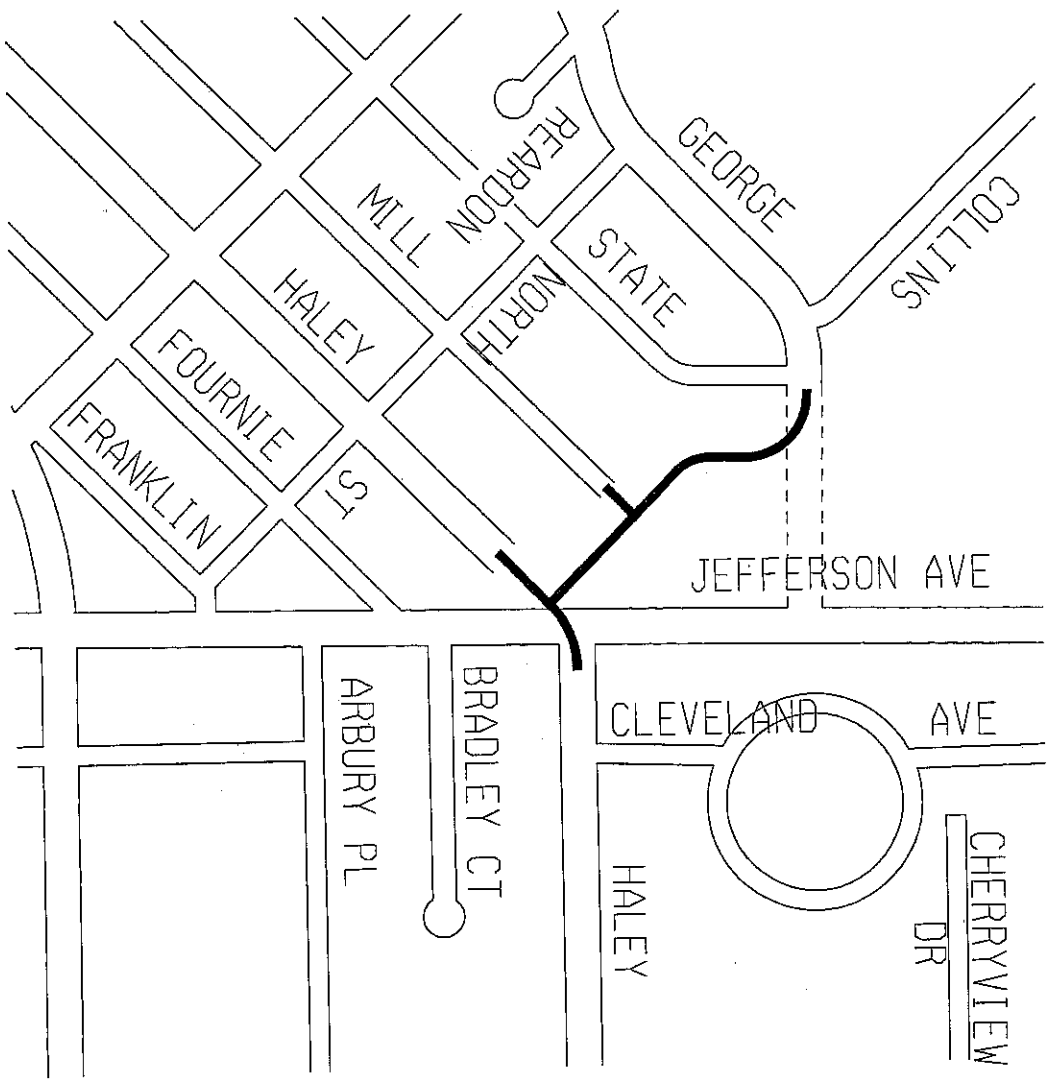

GEORGE STREET RELOCATION FOR
MIDLAND COMMUNITY CENTER

(COST: \$300,000) (CITY: \$150,000)

WASHINGTON ST

E LYON RD

E PATRICK RD

S SAGINAW RD

JAMES SAVAGE RD

WALSH ST

COLORADO ST

IOWA ST

SWEDE AVE

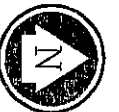

PATRICK ROAD
LYON X-OVER TO SAGINAW
(COST: \$219,000)

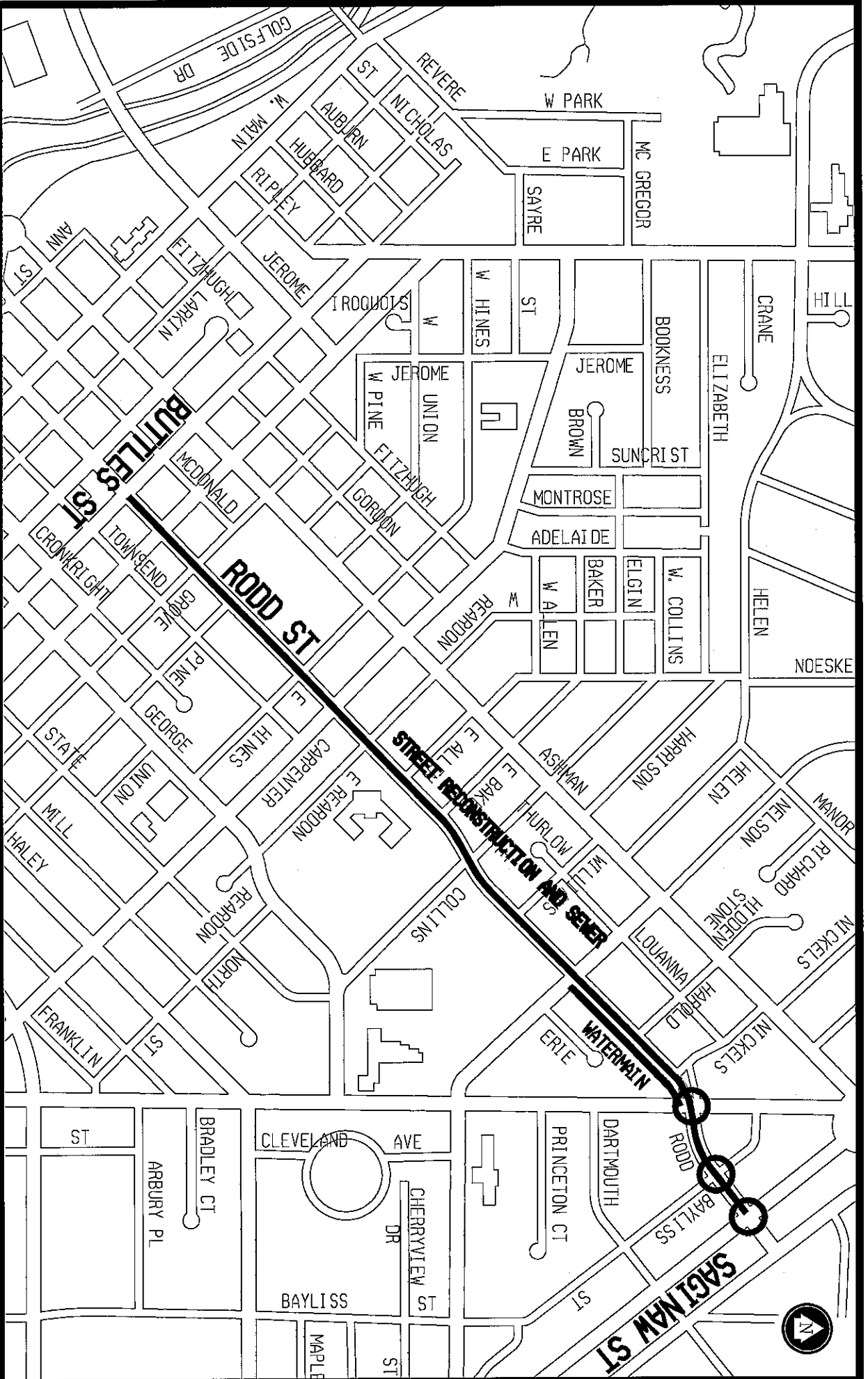

RODD STREET IMPROVEMENTS

**STREET RECONSTRUCTION
BUTTLERS TO SAGINAW
(COST: \$740,000) (CITY: \$459,000)**

**SANITARY SEWER
BUTTLERS TO SAGINAW
(COST: \$100,000)**

**WATERMAIN
NELSON TO JEFFERSON
(COST: \$143,000)**

**WATER MAIN CROSSINGS
BAYLISS, JEFFERSON, AND SAGINAW
(COST: \$81,000)**

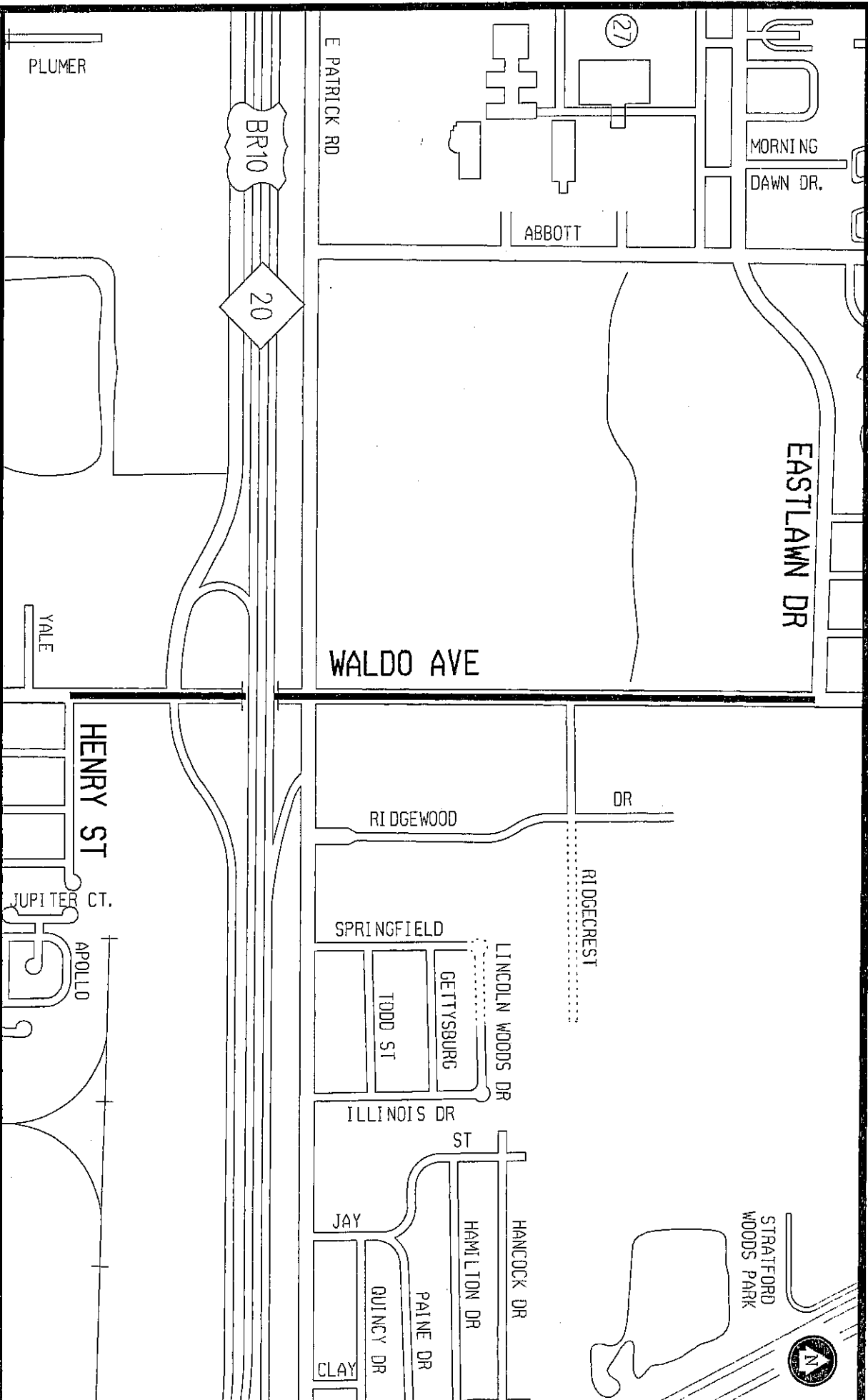

WALDO AVE IMPROVEMENTS
 ROAD RECONSTRUCTION
 EASTLAWN TO HENRY
 (COST: \$455,000)

SANITARY SEWER
 EASTLAWN TO HENRY
 (COST: \$50,000)

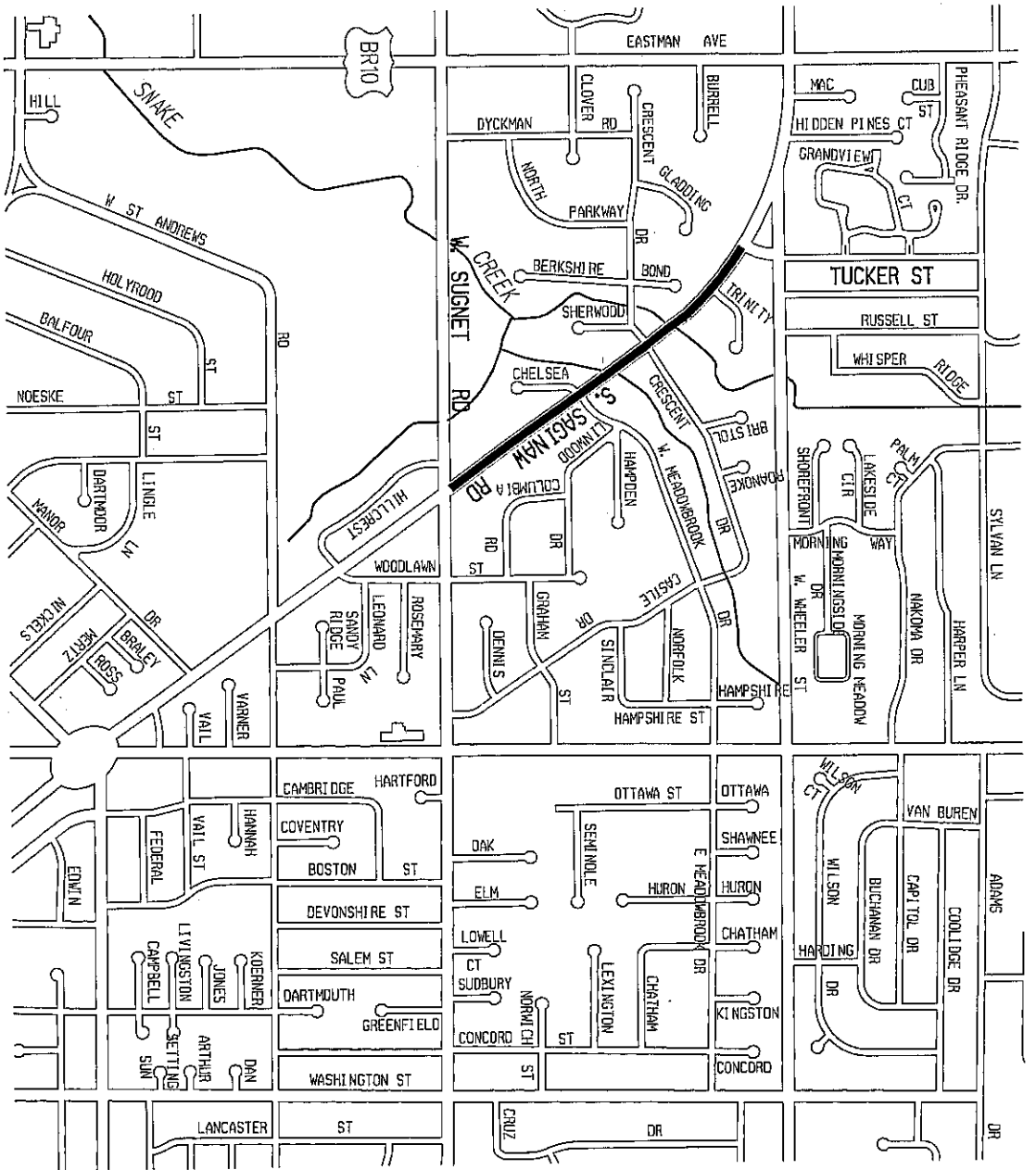

SAGINAW ROAD WIDENING

SUGNET TO TUCKER

(COST: \$895,000) (CITY: \$355,000)



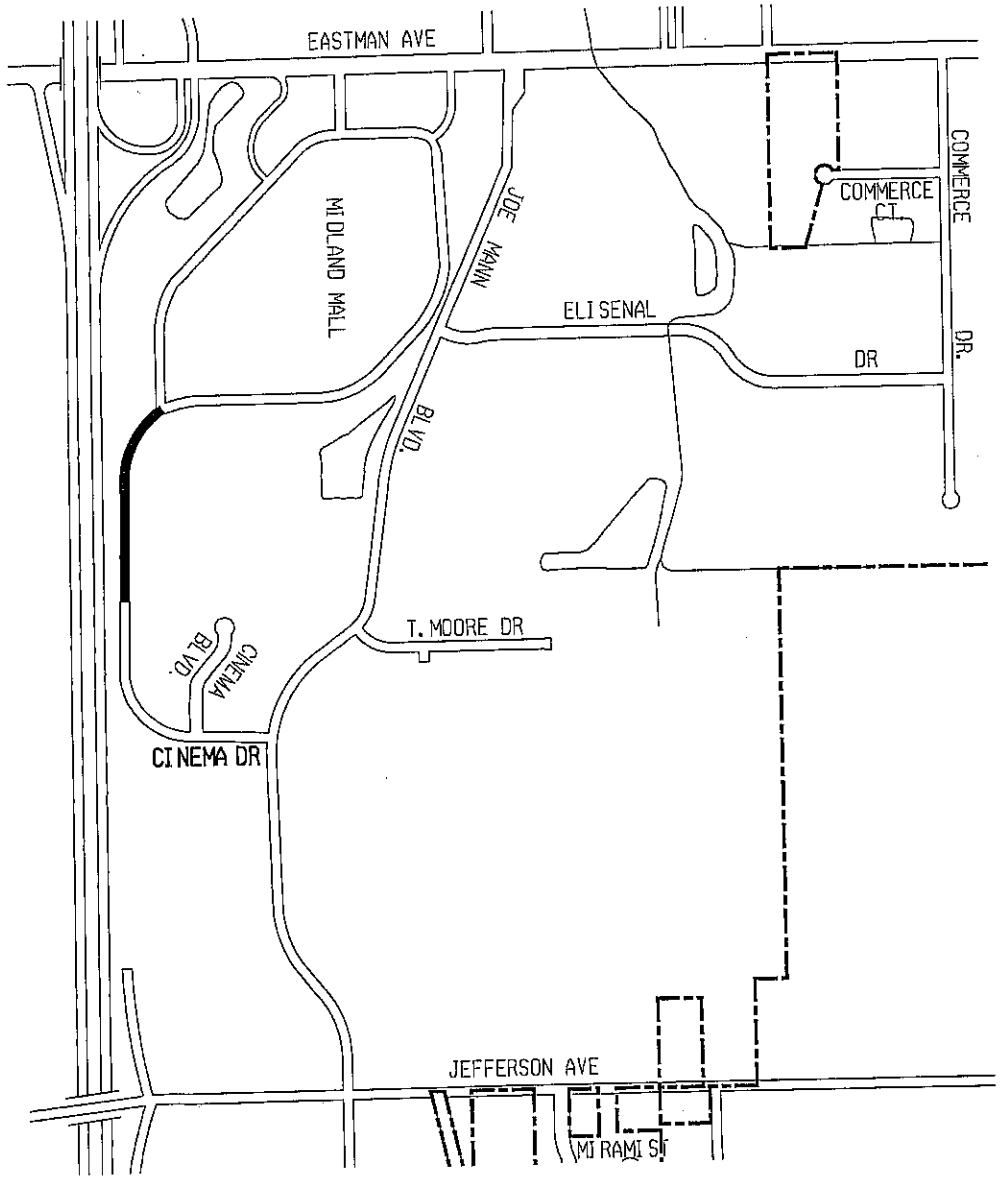

CINEMA DRIVE
 MALL RD. TO N-S 1/4 LINE
 (COST: \$104,000)



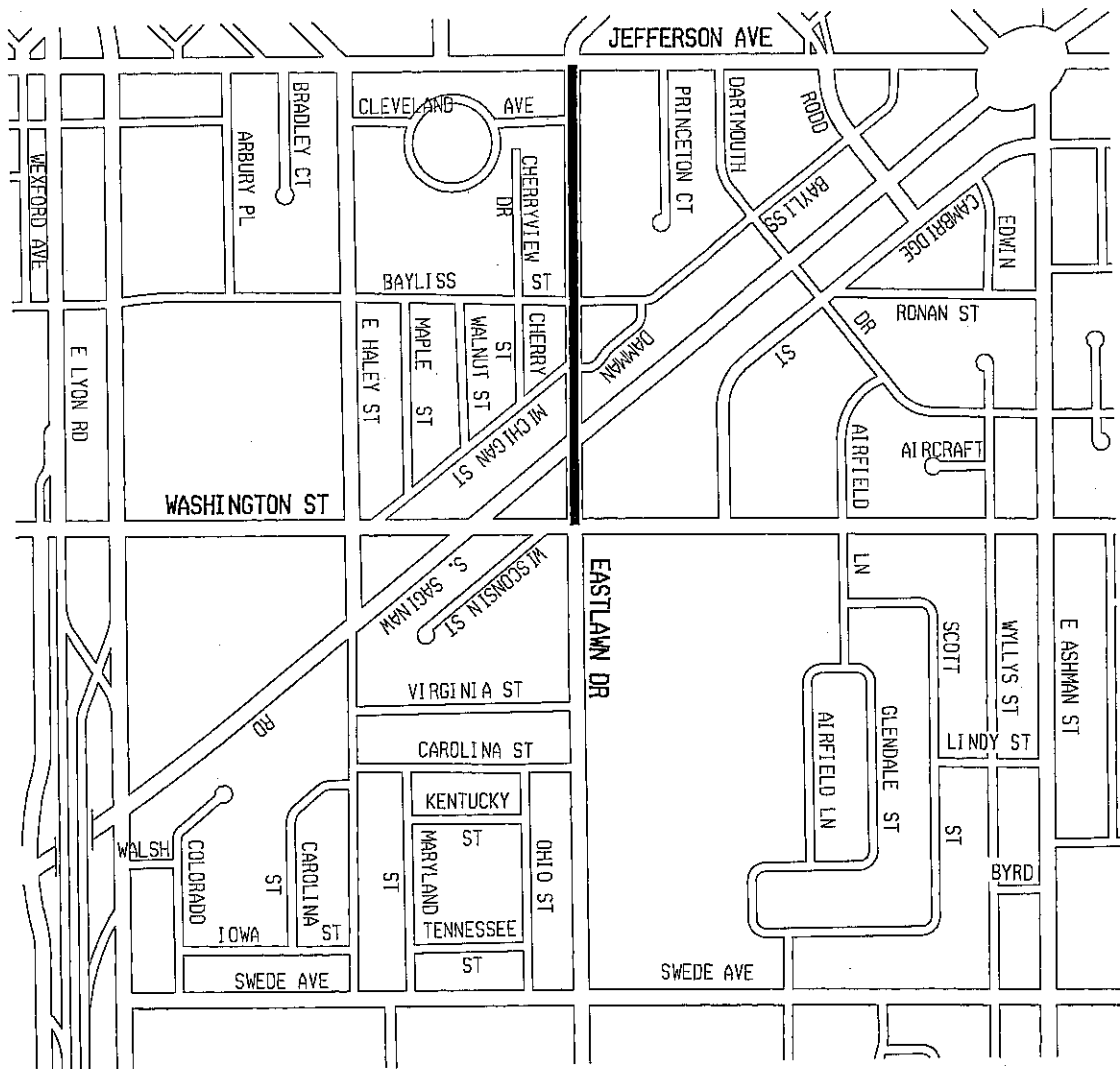

EASTLAWN DRIVE
JEFFERSON TO WASHINGTON
(COST: \$311,000)



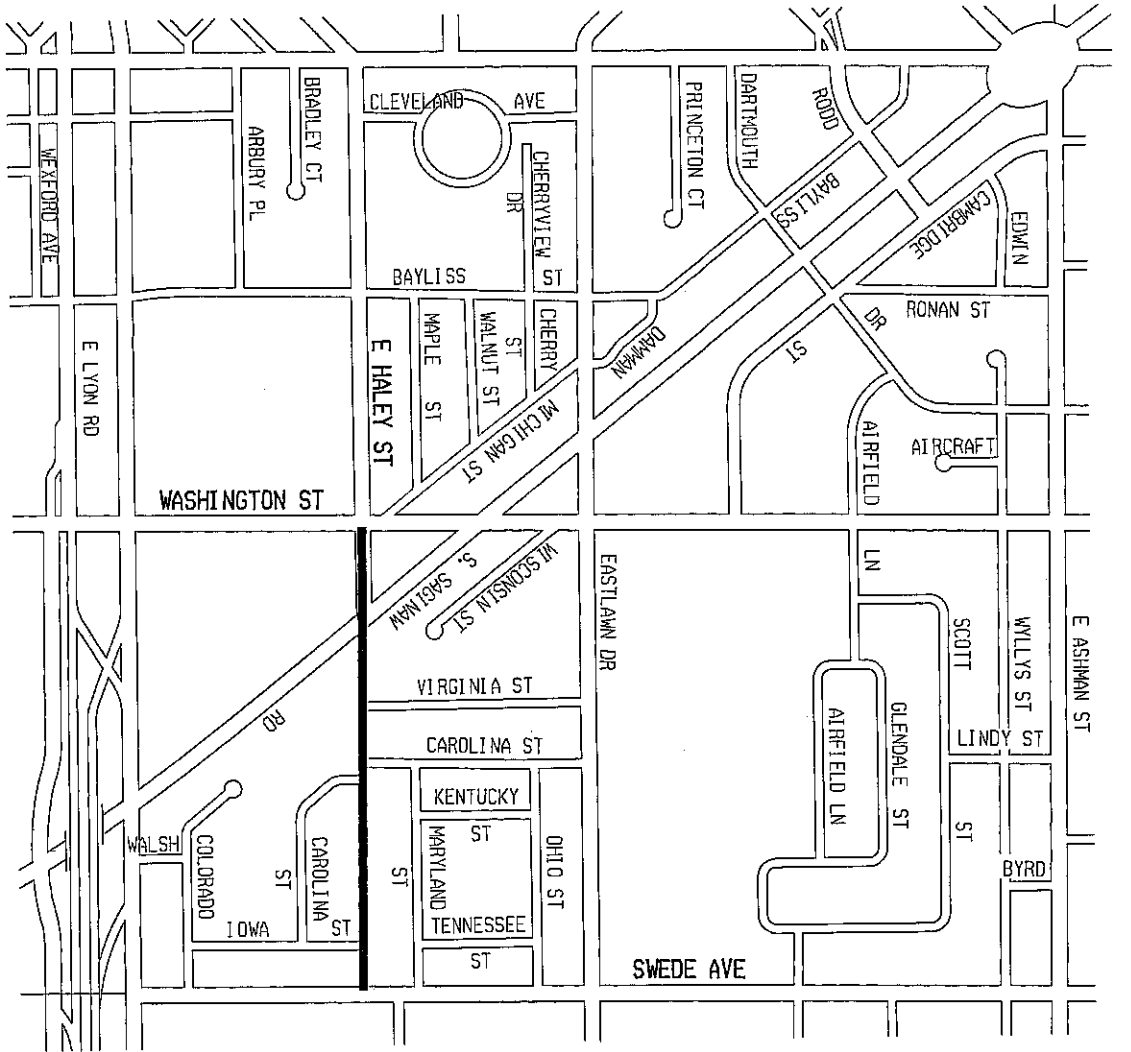

HAILEY STREET

WASHINGTON TO SWEDE

(COST: \$249,000)



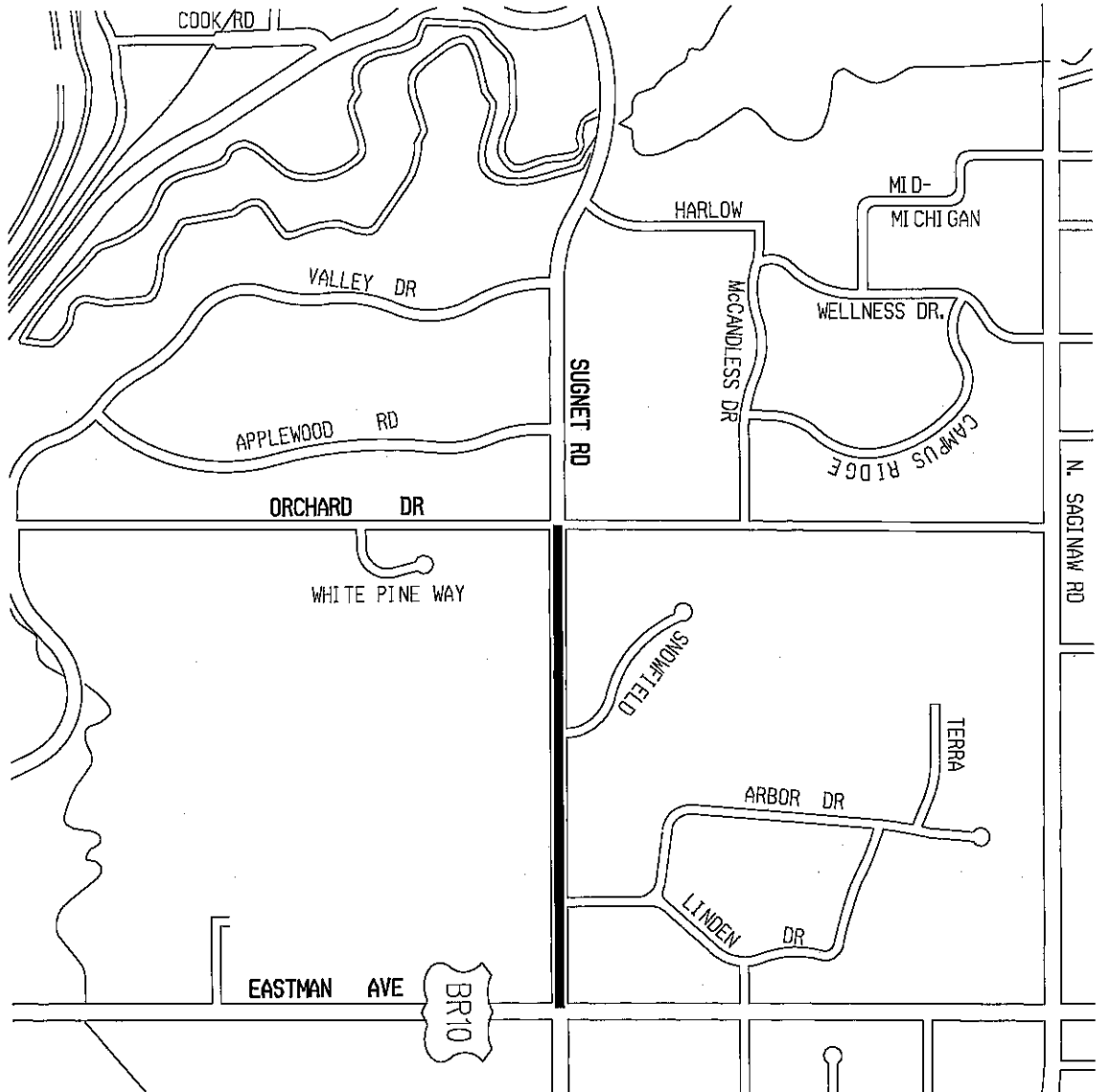

SUGNET ROAD IMPROVEMENTS
ORCHARD TO EASTMAN
(STREET COST: \$201,000) (WATER MAIN COST: \$291,000)

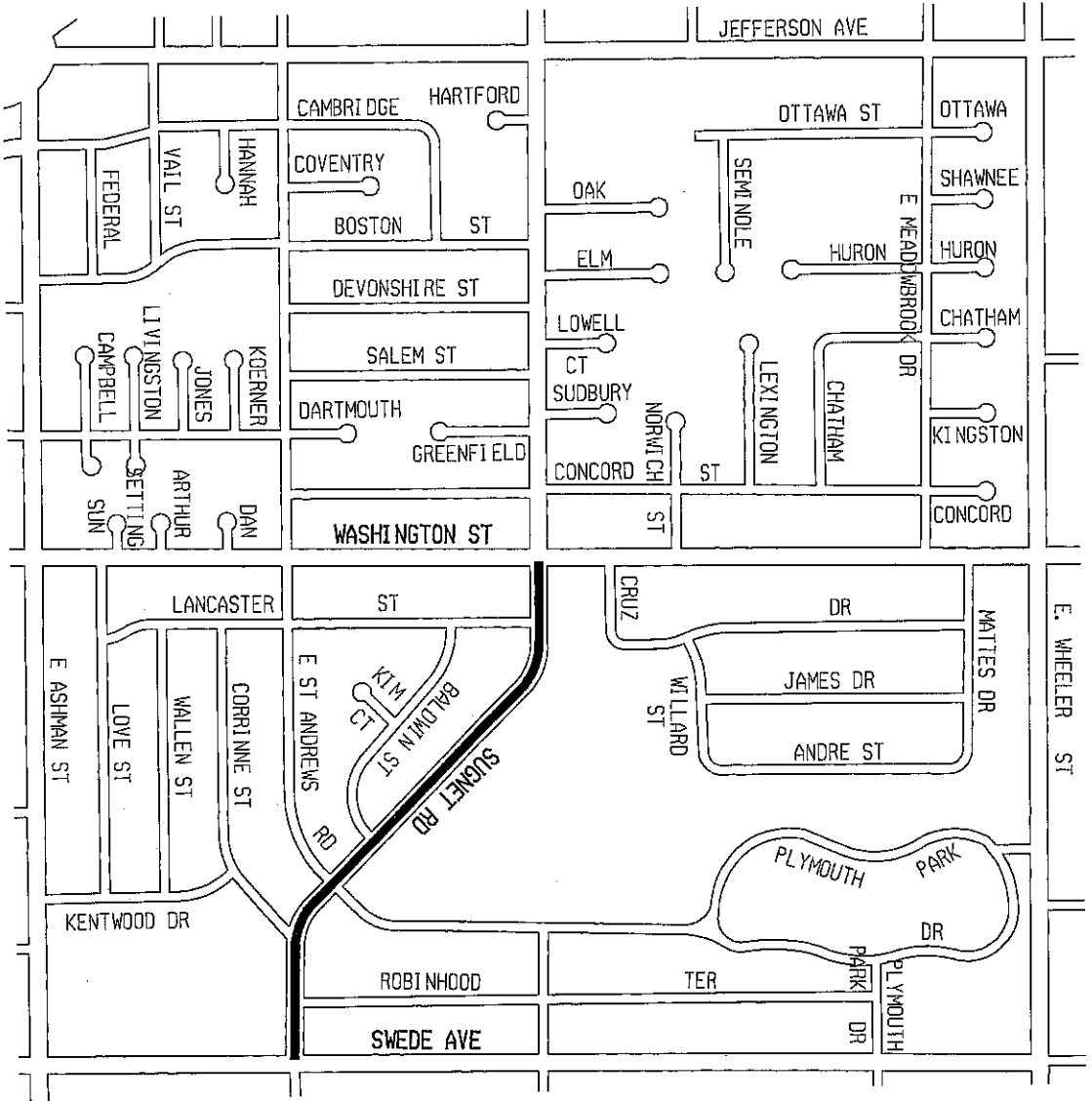

SUGNET ROAD
WASHINGTON TO SWEDE
 (COST: \$290,000)



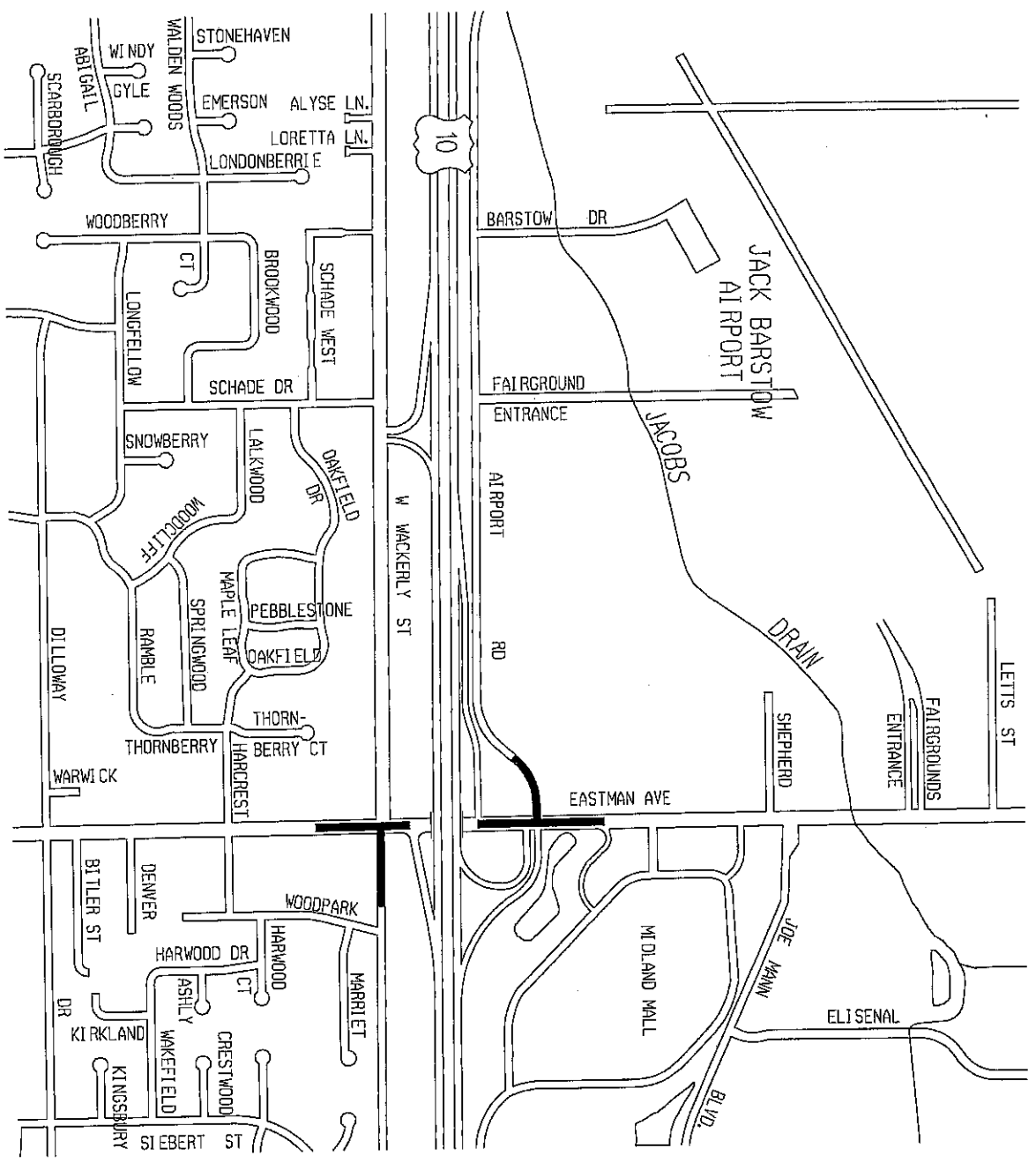

EASTMAN AVENUE TRAFFIC IMPROVEMENTS

(ENGINEERING COST: \$150,000)

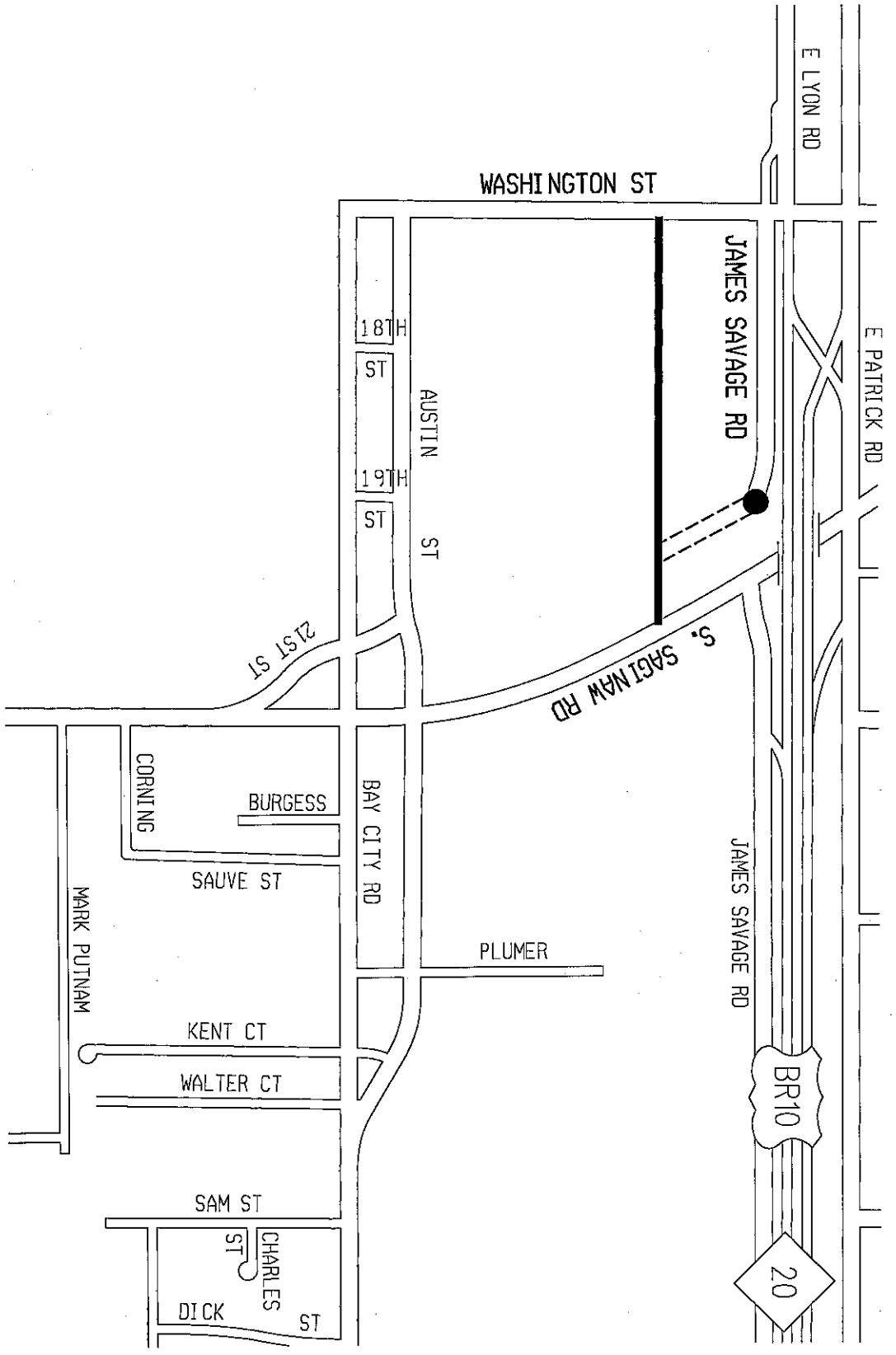

**DOW ROADWAY: JAMES SAVAGE
 CLOSURE AT SAGINAW RD.
 (COST: \$60,000)**

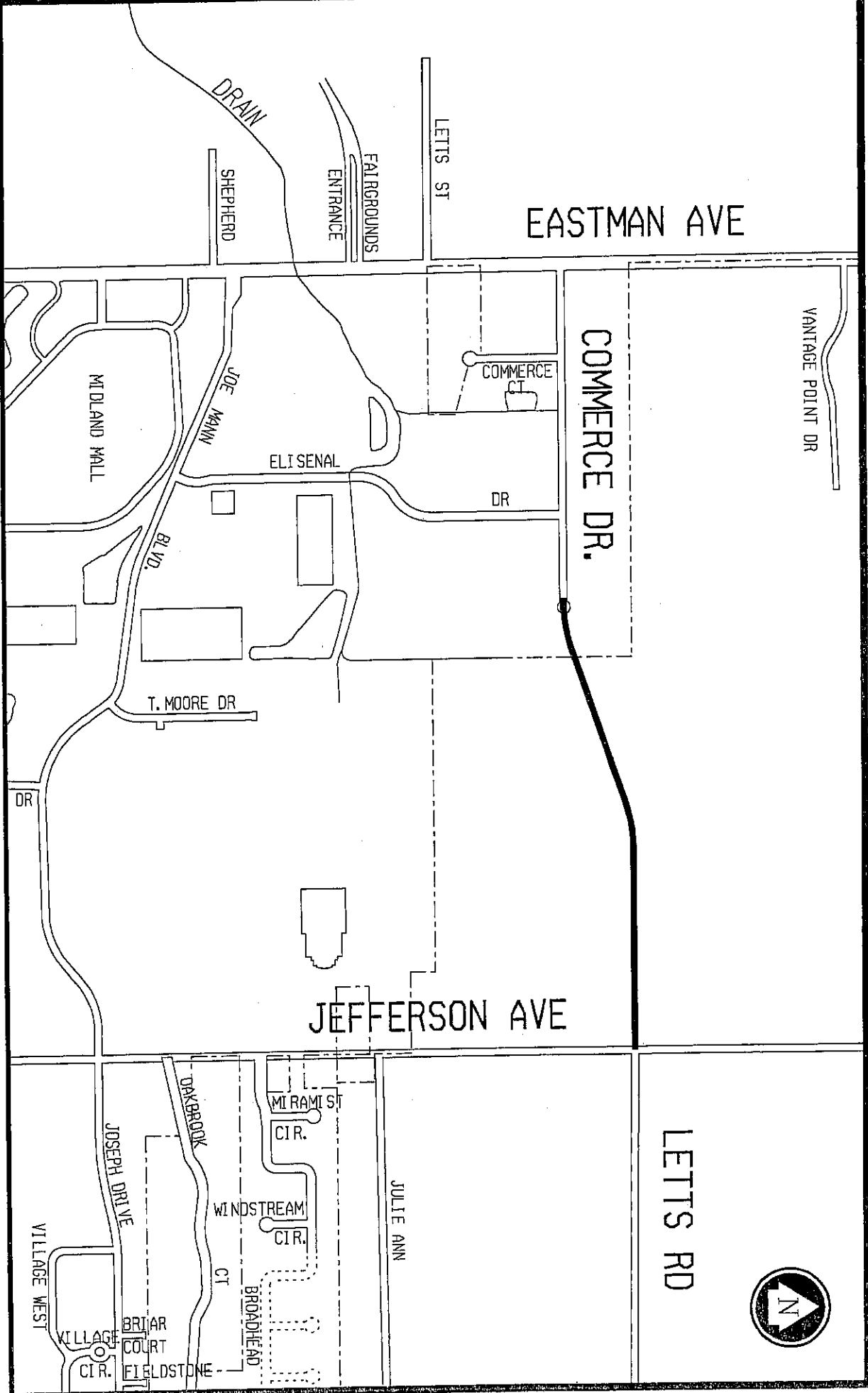

LETTTS ROAD
EASTMAN TO JEFFERSON
(COST: \$1,400,000)

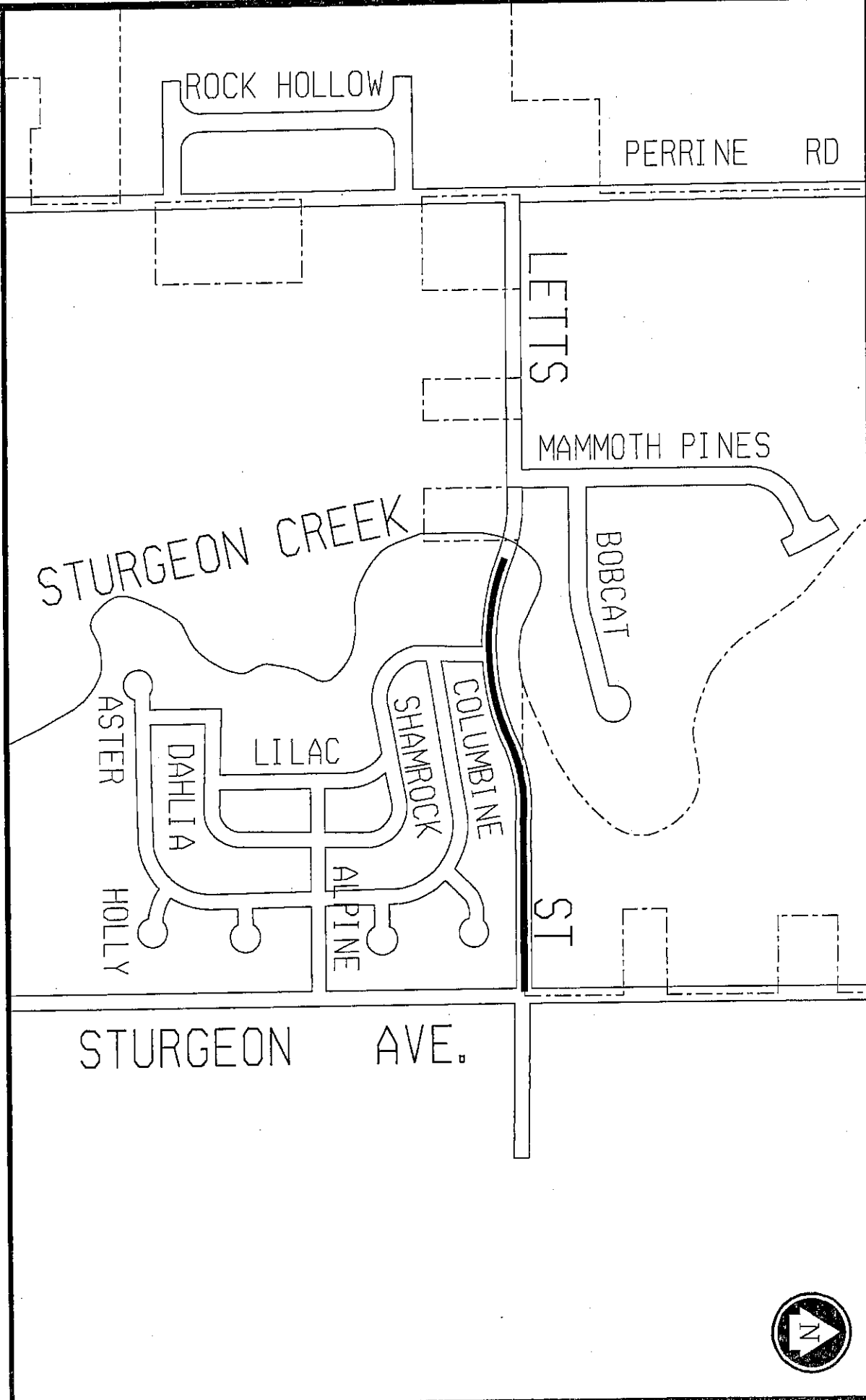

LETT'S STREET

STURGEON ROAD TO STURGEON CREEK
(COST: \$129,000)

SANDOW AREA

ELMER, GLEN, SANDOW, SOLOMON, PRAIRIE
(COST: \$574,000)

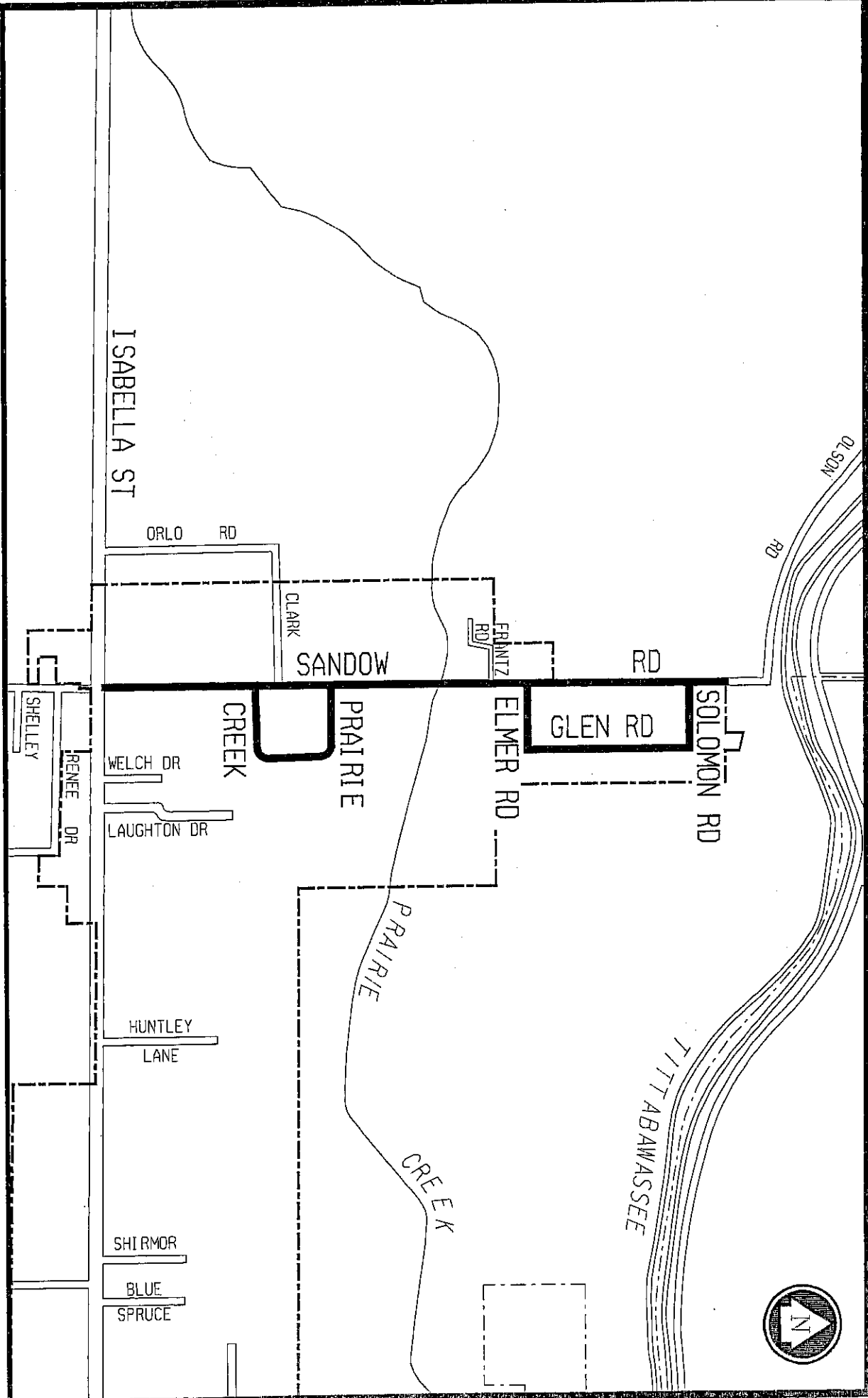

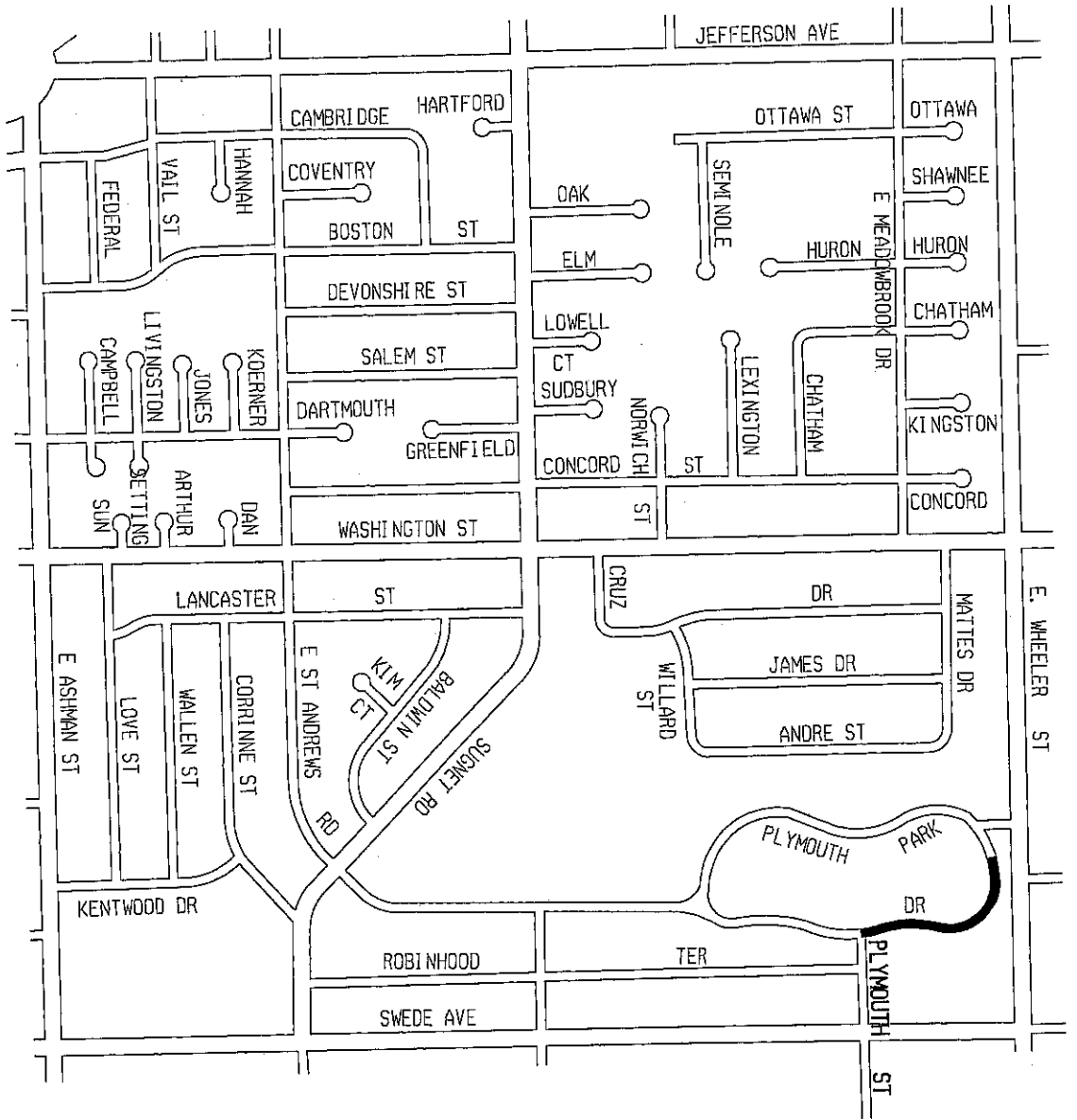

PLYMOUTH PARK DRIVE

PLYMOUTH STREET TO PARK EXIT

(COST: \$110,000)



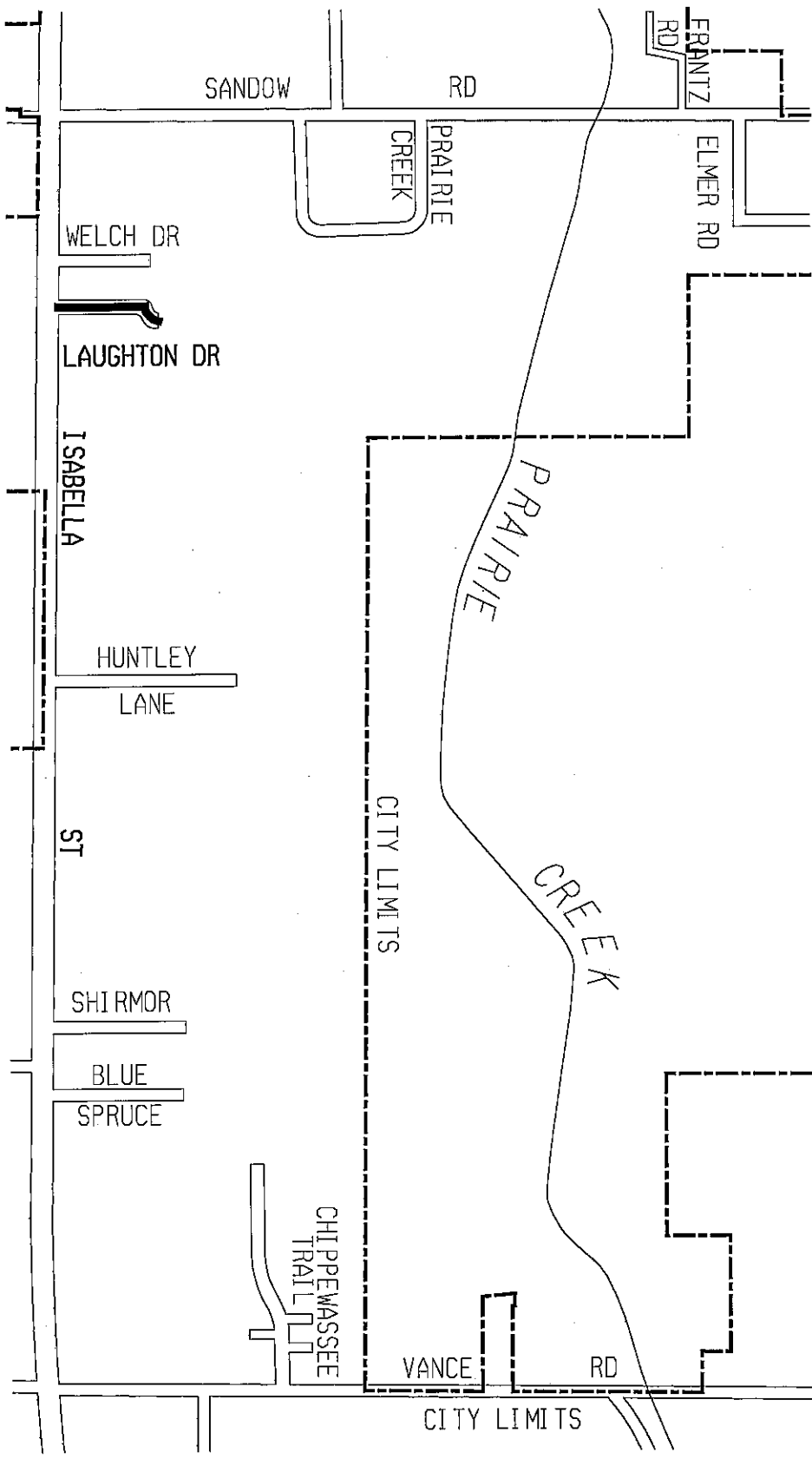

LAUGHTON DRIVE IMPROVEMENTS

ISABELLA TO END OF DRIVE

(STREET COST: \$112,000)

(SANITARY SEWER: \$30,000)

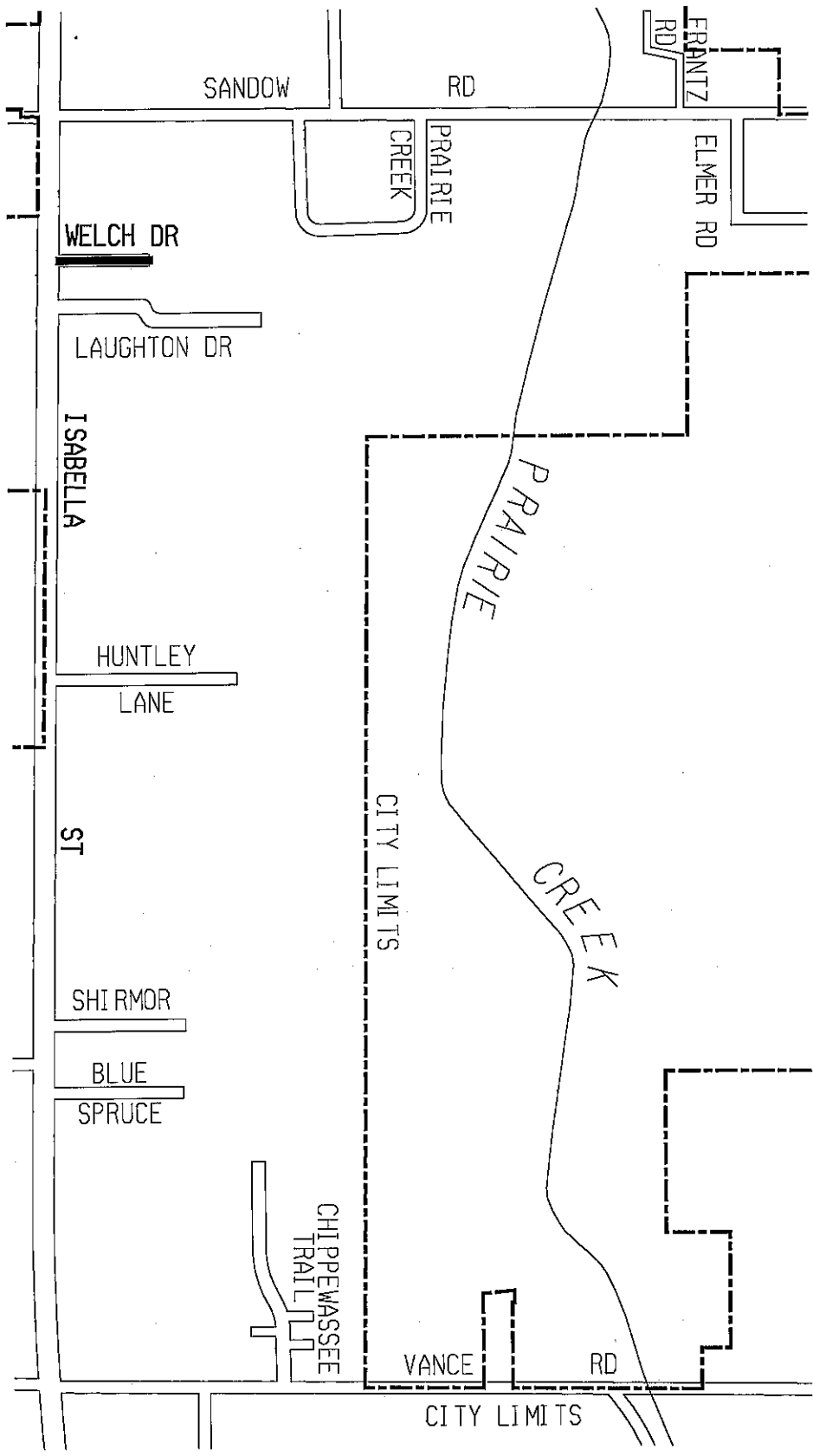

WELCH DRIVE IMPROVEMENTS

ISABELLA TO END OF DRIVE

(STREET COST: \$98,000) (SANITARY SEWER COST: \$25,000)

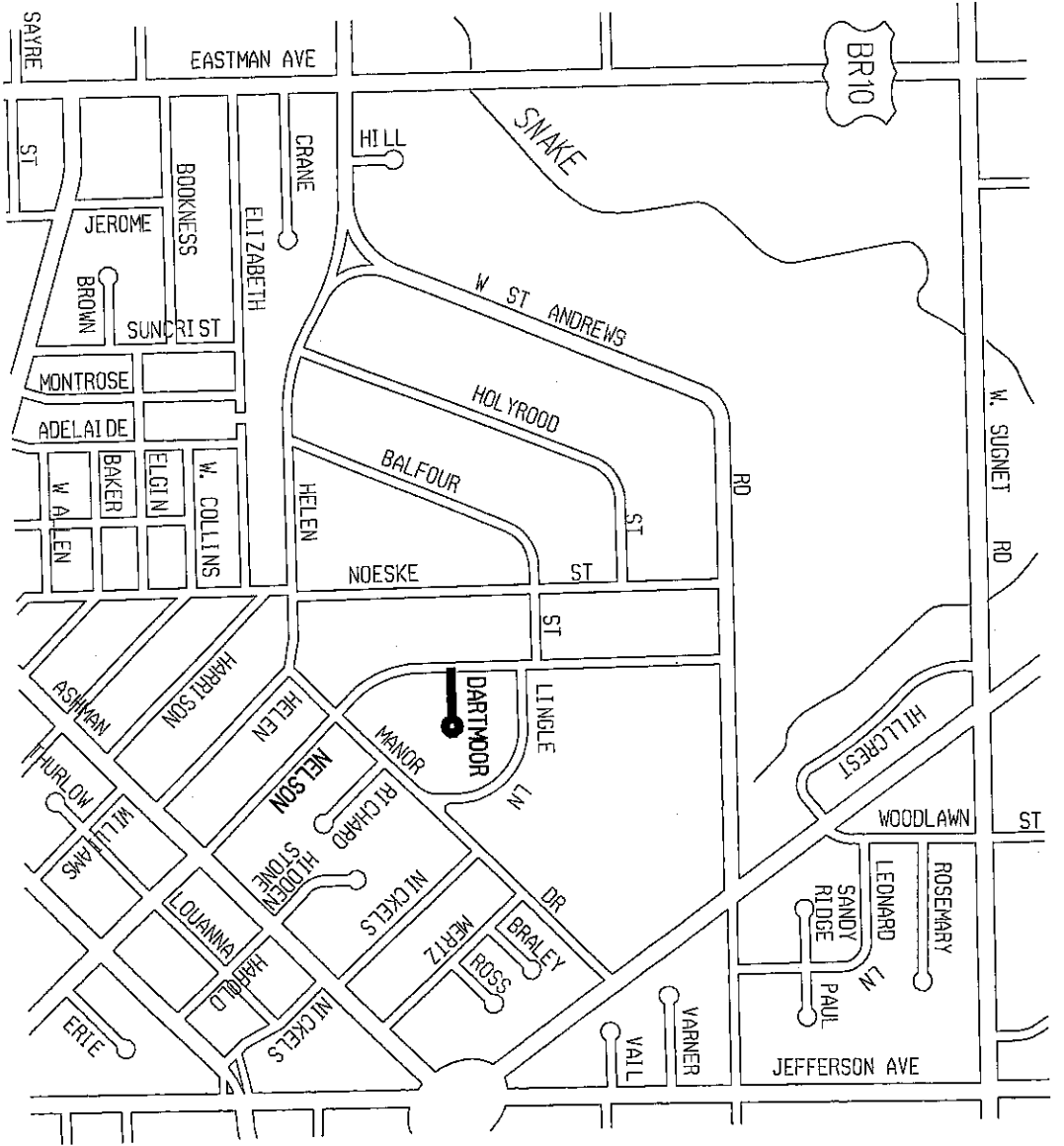

DARTMOOR PLACE
NELSON TO END OF COURT
(COST: \$47,000)

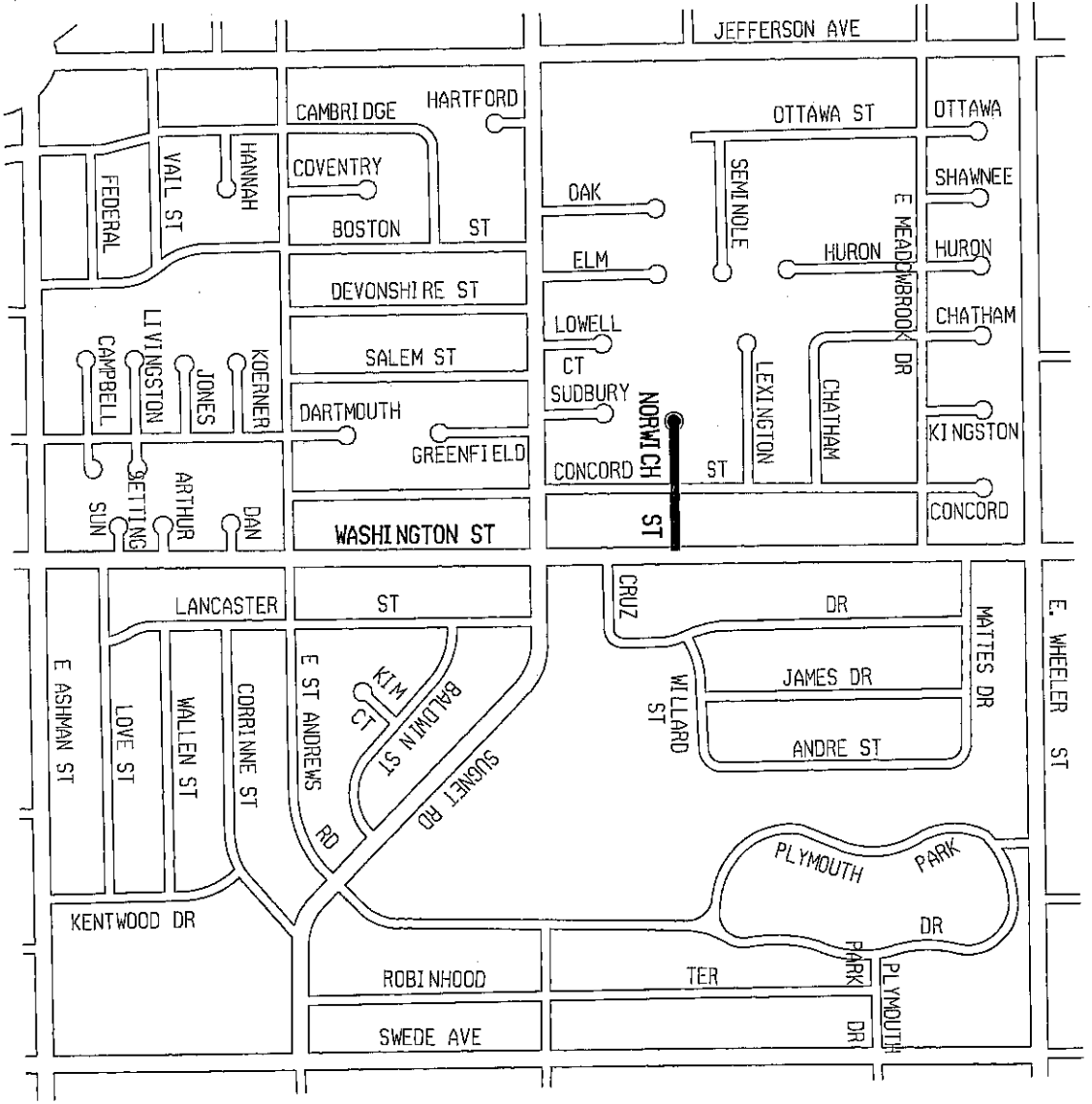

NORWICH STREET
 WASHINGTON TO END OF COURT

(COST: \$125,000)



BAY CITY RD



WILLOW ST

CENTENNIAL

HOLLAND

KUIPERS DR

CENTENNIAL DR

FUTURE WATER

FAST ICE DR

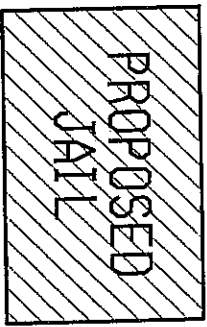

ROCKWELL DR

FUTURE SEWER

FISHER

MONTERAY

INGLEWOOD

EXISTING PUMP STATION

CITY LIMITS

FAST ICE DRIVE IMPROVEMENTS

SANITARY SEWER

WATERMAIN

FISHER ROAD TO FAST ICE DRIVE

END OF CENTENNIAL TO FAST ICE

(COST: \$76,000)

(CITY: \$50,000)

(COST: \$195,000)

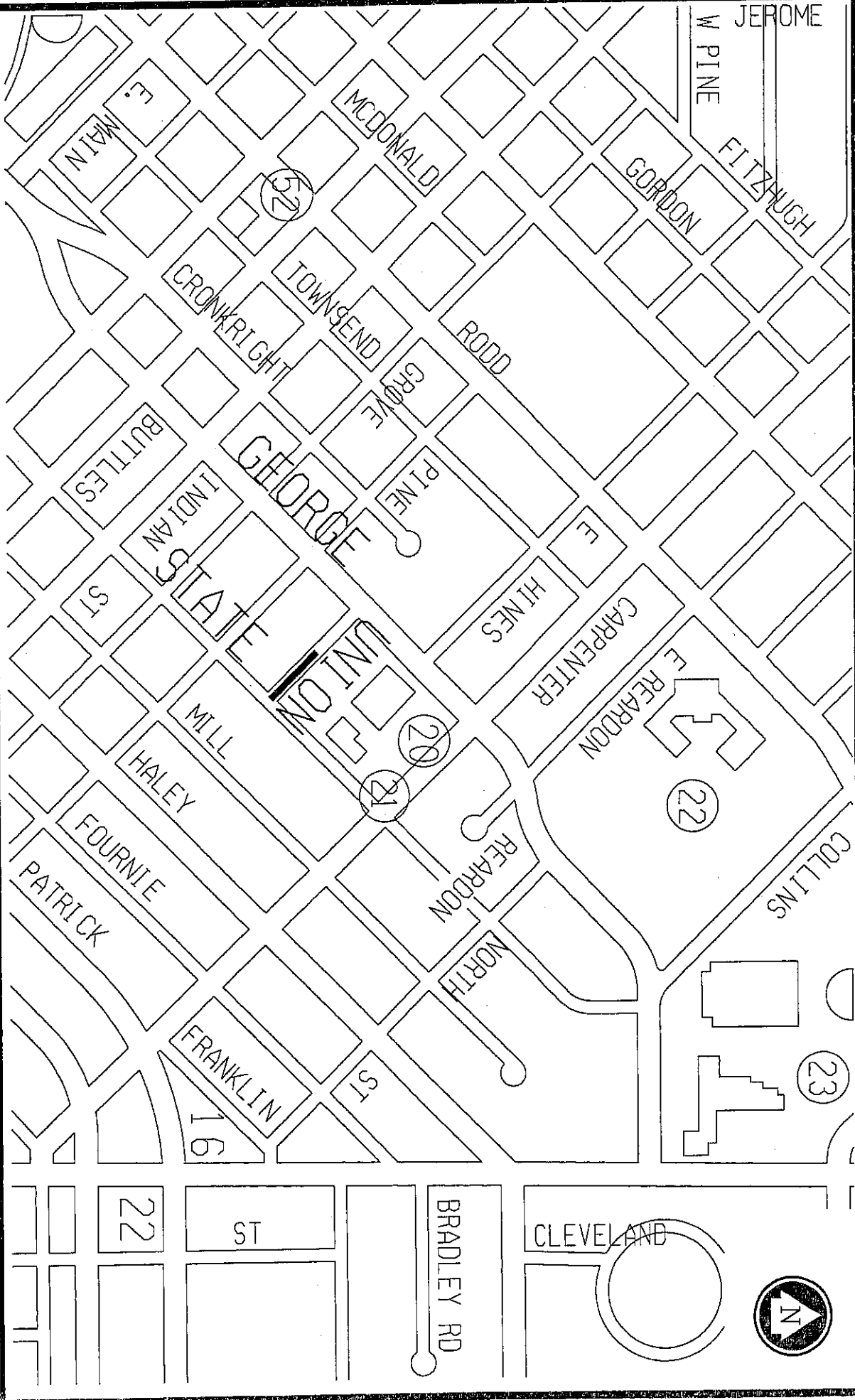

UNION STREET SANITARY SEWER

STATE ST TO 200' WEST

(COST: \$24,000) (CITY: \$20,000)

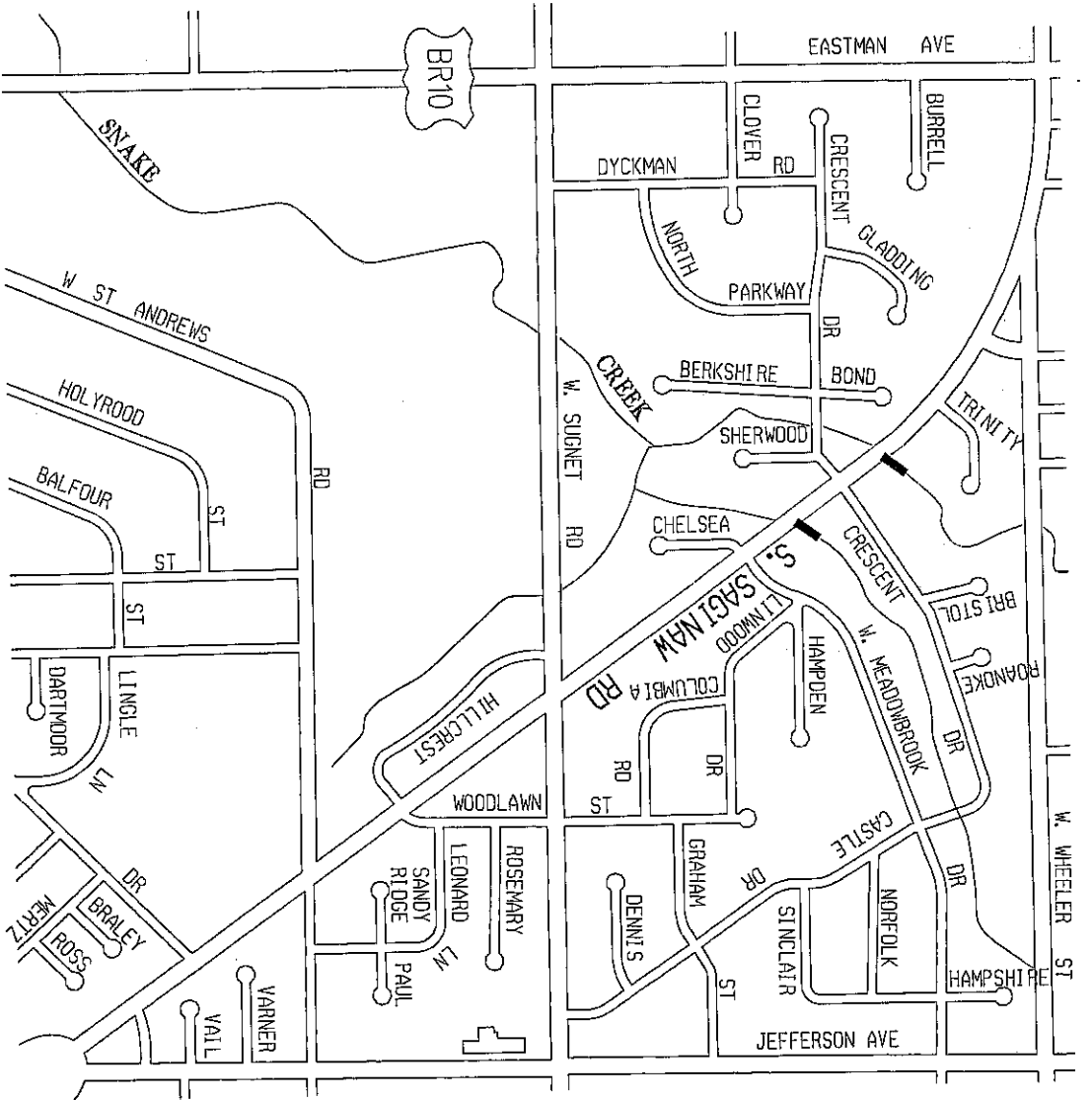

SAGINAW ROAD DRAIN EXTENSIONS SNAKE CREEK DRAIN CROSSINGS (COST: \$72,000)



PATRICK RD

SAGINAW

CAROLINA ST

ST

IOWA

COLORADO

SWEDE AVE

ABBOTT

JAMES SAVAGE RD

BR10

PATRICK ROAD WATER MAIN

SAGINAW TO SWEDE

(COST: \$178,000)

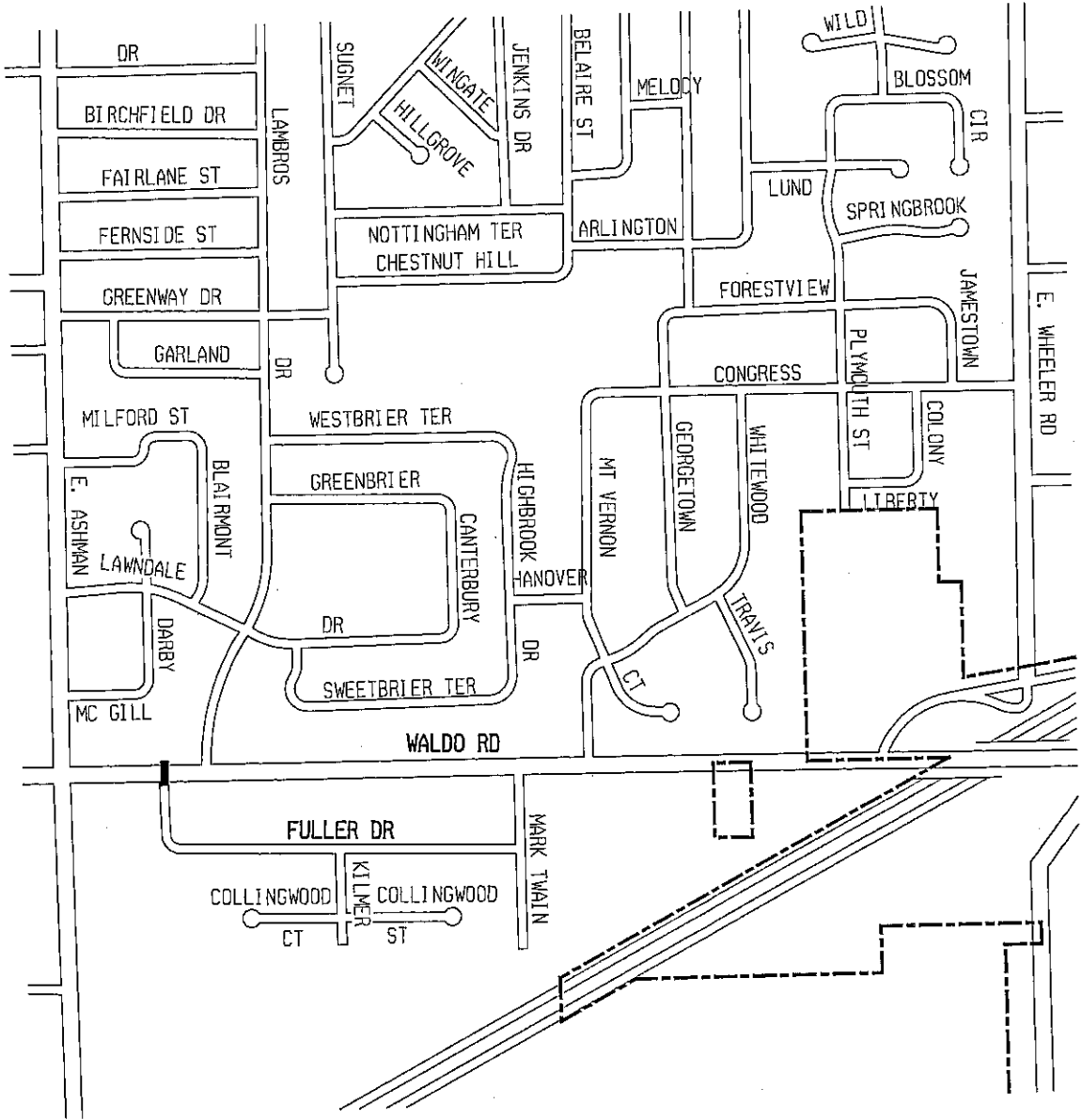

FULLER DRIVE WATER MAIN
CROSSING AT WALDO
(COST: \$25,000)

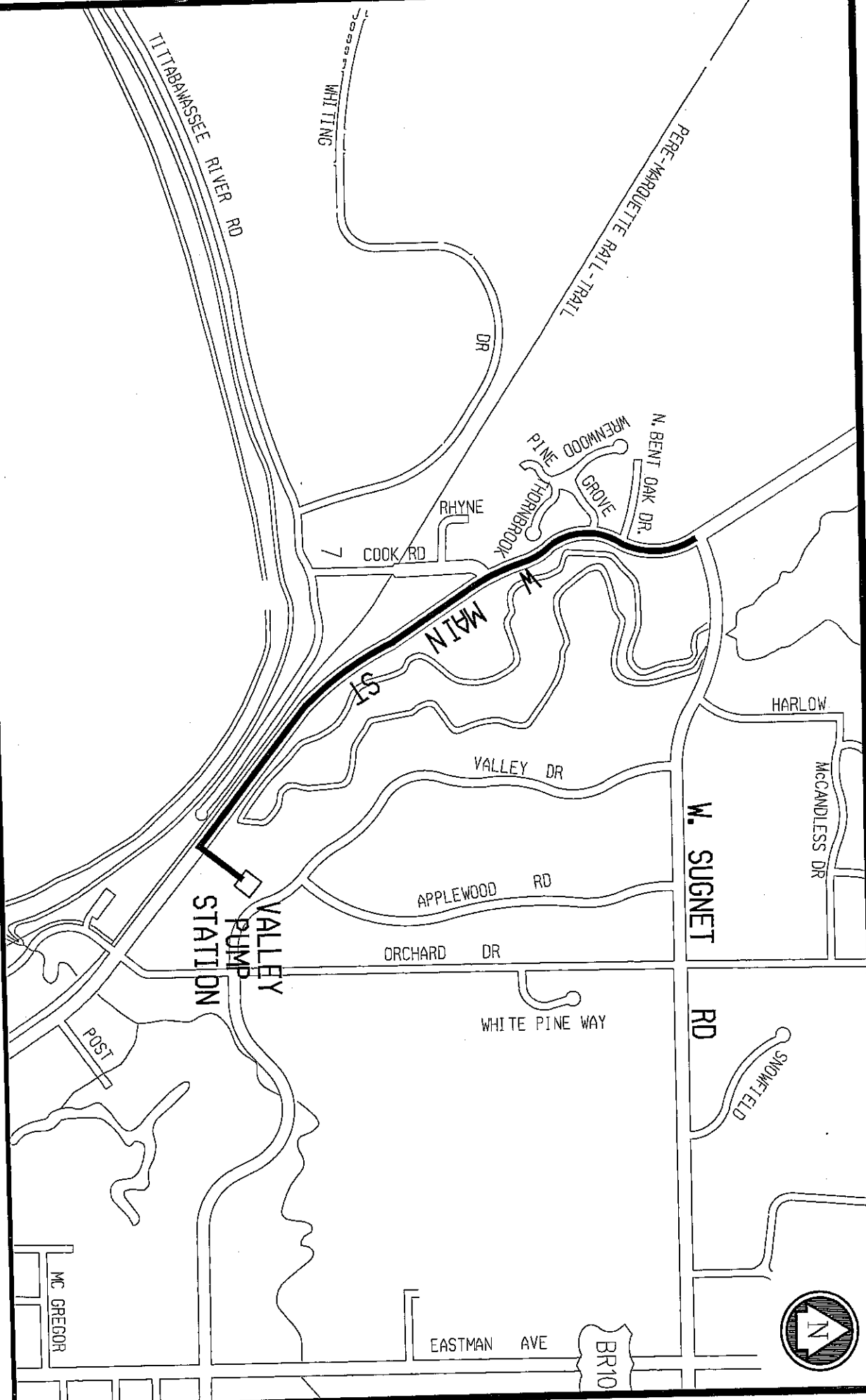

MAIN STREET WATER MAIN
VALLEY PUMP HOUSE TO SUGNET
(COST: \$592,000)

RECEIVED
CITY CLERK
MIDLAND, MICHIGAN

2007 JAN 11 A 10: 54

Ashelia Sischak

308 W. Chapel Lane
Midland, MI 48640

January 11, 2007

Orig: mgr.
cc: Clerk
Eng

Members of Midland City Council:

Tom Adams
Bruce Johnson
Hollis McKeag
James Myers
Joseph Rokosz

The Midland Daily News recently had an article about a proposal by the Community Center for a road change on George Street in front of the Community Center as part of an overall beautification program.

The article mentioned that the total cost of the project would be about \$3 million and the Community Center's proposal was that the city should pay about \$300,000 of the cost which they believe are attributable to road changes.

The article mentioned safety concerns of people crossing the road from the parking lot to the Community Center. I use the Community Center from time to time and agree there could be safety issues.

Having said that, what really is being proposed by the Community Center is a beautification project. The safety issue can easily be addressed by placing a stop sign or traffic light on the road in front of the Community Center. In any other safety situation of this type, a stop sign or traffic light would be the proposed solution. In reality, the relocation of the road is to enhance the beautification project.

If the Community Center wants to go ahead with the beautification project, I believe the entire cost of the project should be funded by the Community Center and no city road funds should be used. This project would not add any significant road improvement benefit to the city.

The city has more roads that need to be improved than it has available funds. That is why the city has a prioritization process. We should not be using the road fund "to help pay the cost of other projects" no matter how worth while they may be in the view of some organizations in town.

Road projects are and should be done on a priority basis and if the city has funds for this type of project, it raises questions about the appropriateness of the amount in the road fund and the fairness of the allocation process used for road projects. This issue recently came up over the use of city road funds for improvements involving the baseball stadium.

I have no problem with the beautification project proposed by the Community Center. It may very well be a good project. But I do believe and believe others will agree as well that does not make it a project for city funding.

Very truly yours,

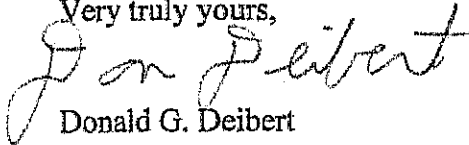
A handwritten signature in cursive script that reads "Don Deibert". The signature is written in dark ink and is positioned above the printed name.

Donald G. Deibert

989-839-0363